

Part number

PEW 3235 SI



Flush-mounting plug, PLUSO series, 3 poles + N + PE, 3 h (red), 32 A, 380 V

Product description	
Product type	Plug Flush-mounting
Series	PEW...SI, PLUSO
N. of poles	3 poles + N + 
Clock position	3
Technical data	
Current	32 A
Voltage	220/380V (50Hz) 250/440V (60Hz)
IP degree of protection	IP67
Further technical details	
Operating temperature range (min, max)	-25°C ... +40°C

Material properties	
Colour	RAL 7035 grey, RAL 3000 red
Approvals / Standards	
Reference standard	EN 60309-1 and -2
General ordering information	
EAN13 code	8015747157865

Part number

PEW 3235 SI



Catalogue drawings

(16 / 32A) PEW ... SI

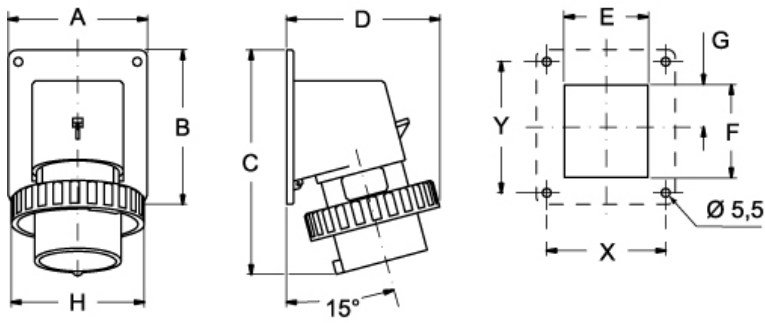

PEW ... SI	A	B	C	D	E	F	G	H	X	Y
16A 2P+⊕	65	82	126	81	41	43	21,5	70	52	60
3P+⊕	65	82	126	81	47	43	24,5	78	52	60
3P+N+⊕	90	100	146	93	54	60	27,5	86	77	85
32A 2P+⊕	90	100	160	101	55	60	27,5	92	77	85
3P+⊕	90	100	160	101	55	60	27,5	92	77	85
3P+N+⊕	90	100	160	101	62	60	27,5	100	77	85

Notes