

Part number

# PEW 1624 PP



Wall-mounting socket outlet, PLUSO series, 3 poles + PE, 2 h (green), 16 A, > 50 V

#### Product description

|                       |   |
|-----------------------|---|
| <b>Product type</b>   | Socket<br>Wall-mounting   |
| <b>Series</b>         | PEW...PP, PLUSO   |
| <b>N. of poles</b>    | 3 poles +  |
| <b>Clock position</b> | 2   |

#### Technical data

|                                |        |
|--------------------------------|--------|
| <b>Current</b>                 | 16 A   |
| <b>Voltage</b>                 | > 50 V |
| <b>IP degree of protection</b> | IP67   |

#### Further technical details

|   |                 |
|---|-----------------|
| <b>Weight</b>                                 | 330,00 g        |
| <b>Operating temperature range (min, max)</b> | -25°C ... +40°C |

#### Material properties

|                              |   |
|------------------------------|---|
| <b>Colour</b>                | RAL 7035 grey, RAL 6017 green   |
| <b>RoHs conformity</b>       | Compliant with exemption<br>6(c): copper alloy containing up to 4% lead by weight |
| <b>China RoHs - EFUP</b>     | 50  |
| <b>REACH SVHC substances</b> | Yes<br>Lead   |
| <b>SCIP number</b>           | Ca7de37f-add8-4b77-9861-279c94903ade  |

#### Approvals / Standards

|                           |                   |
|---------------------------|-------------------|
| <b>Reference standard</b> | EN 60309-1 and -2 |
|---------------------------|-------------------|

#### General ordering information

|                   |               |
|-------------------|---------------|
| <b>EAN13 code</b> | 8015747156745 |
|-------------------|---------------|

#### Packaging Information

|                              |                       |
|------------------------------|-----------------------|
| <b>Packaging length</b>      | 330,00 mm             |
| <b>Packaging height</b>      | 175,00 mm             |
| <b>Packaging width</b>       | 295,00 mm             |
| <b>Packaging weight</b>      | 3,55 kg               |
| <b>Packaging volume</b>      | 17,04 dm <sup>3</sup> |
| <b>Packaging description</b> | Carton box            |
| <b>Packaging quantity</b>    | 10 Pcs                |
| <b>Packaging EAN code</b>    | 8015747217903         |

Part number

# PEW 1624 PP



Catalogue drawings

( 16 / 32A) PEW ... PP

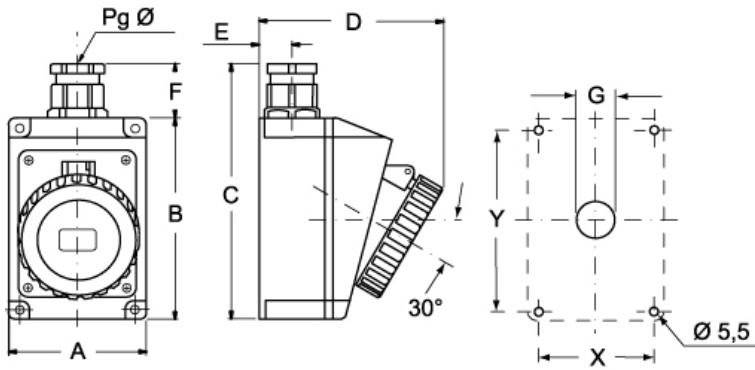

| PEW ... PP      | A   | B   | C   | D   | E  | F  | G   | X  | Y   | Pg Ø |
|-----------------|-----|-----|-----|-----|----|----|-----|----|-----|------|
| <b>16A</b> 2P+⊕ | 75  | 115 | 150 | 105 | 19 | 33 | Ø22 | 65 | 105 | 16   |
| 3P+⊕            | 75  | 115 | 150 | 108 | 19 | 33 | Ø22 | 65 | 105 | 16   |
| 3P+N+⊕          | 100 | 130 | 172 | 120 | 22 | 33 | Ø22 | 85 | 115 | 21   |
| <b>32A</b> 2P+⊕ | 100 | 130 | 172 | 120 | 22 | 42 | Ø28 | 85 | 115 | 21   |
| 3P+⊕            | 100 | 130 | 172 | 120 | 22 | 42 | Ø28 | 85 | 115 | 21   |
| 3P+N+⊕          | 100 | 130 | 172 | 120 | 22 | 42 | Ø28 | 85 | 115 | 21   |

Notes