

Part number

# PEW 125123SI



Flush-mounting plug, PLUSO series, 2 poles + PE, 12 h (white), 125 A

#### Product description

<b>Product type</b>	Plug Flush-mounting
<b>Series</b>	PEW...SI, PLUSO
<b>N. of poles</b>	2 poles + 
<b>Clock position</b>	12

#### Technical data

<b>Current</b>	125 A
<b>Voltage</b>	ins. transformer
<b>IP degree of protection</b>	IP67

#### Further technical details

<b>Operating temperature range (min, max)</b>	-25°C ... +40°C
---	-----------------

#### Material properties

<b>Colour</b>	RAL 7035 grey, RAL 9010 white
---------------	-------------------------------

#### Approvals / Standards

<b>Reference standard</b>	EN 60309-1 and -2
---------------------------	-------------------

#### General ordering information

<b>EAN13 code</b>	8015747155984
-------------------	---------------

Part number

# PEW 125123SI



Catalogue drawings

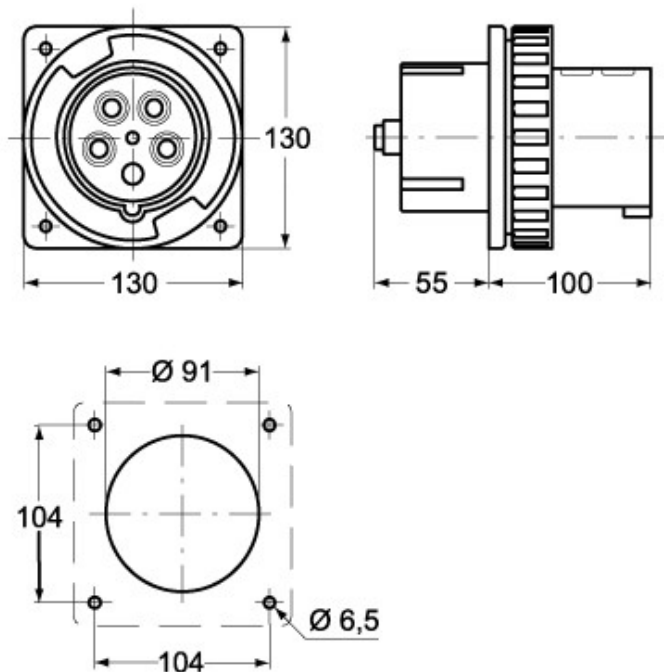

---

Notes