

Part number

PE 32115 PQ



Flush-mounting socket outlet, PLUSO series, 3 poles + N + PE, 11 h (red), 32 A, 250/440 ÷ 265/460 V, straight

Product description

Product type	Socket Flush-mounting
Series	PE...PQ, PLUSO
N. of poles	3 poles + N + 
Clock position	11
Specification	Straight

Technical data

Current	32 A
Voltage	250/440V ÷ 265/460V
IP degree of protection	IP44

Further technical details

Operating temperature range (min, max)	-25°C ... +40°C
---	-----------------

Material properties

Colour	RAL 7035 grey, RAL 3000 red
---------------	-----------------------------

Approvals / Standards

Reference standard	EN 60309-1 and -2
---------------------------	-------------------

General ordering information

EAN13 code	8015747155250
-------------------	---------------

Part number

PE 32115 PQ



Catalogue drawings

(16 / 32A) PE ... PQ

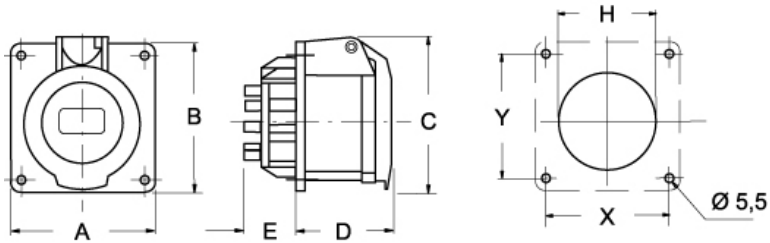

PE ... PQ	A	B	C	D	E	H	X	Y
16A 2P+⊕	65	65	71	52	27	60	52	52
	65	65	75	53	27	61,5	52	52
	80	80	86	53	27	70	60	60
32A 2P+⊕	80	80	87	62	28	68	60	60
	80	80	87	62	28	68	60	60
	80	80	92	62	28	73	60	60

Notes