

Part number

# PB 32002 PP



Wall-mounting socket outlet, PLUSO series, 2 poles, 32 A, 20 ÷ 25 V

Product description		Material properties	
<b>Product type</b>	Socket Wall-mounting	<b>Colour</b>	RAL 7035 grey, RAL 4001 lilac
<b>Series</b>	PB...PP, PLUSO	<b>RoHs conformity</b>	Compliant with exemption 6(c): copper alloy containing up to 4% lead by weight
<b>N. of poles</b>	2 poles	<b>China RoHs - EFUP</b>	50
<b>Clock position</b>	No key way	<b>REACH SVHC substances</b>	Yes Lead
Technical data		<b>SCIP number</b>	Ca7de37f-add8-4b77-9861-279c94903ade
<b>Current</b>	32 A	Approvals / Standards	
<b>Voltage</b>	20 ÷ 25 V	<b>Reference standard</b>	EN 60309-1 and -2
<b>IP degree of protection</b>	IP44	General ordering information	
Further technical details		<b>EAN13 code</b>	8015747061773
<b>Weight</b>	170,00 g	Packaging Information	
<b>Operating temperature range (min, max)</b>	-25°C ... +40°C	<b>Packaging length</b>	208,00 mm
		<b>Packaging height</b>	140,00 mm
		<b>Packaging width</b>	290,00 mm
		<b>Packaging weight</b>	1,92 kg
		<b>Packaging volume</b>	8,44 dm <sup>3</sup>
		<b>Packaging description</b>	Carton box
		<b>Packaging quantity</b>	10 Pcs
		<b>Packaging EAN code</b>	8015747061780

Part number

# PB 32002 PP



Catalogue drawings

(16 / 32A) PB ...PP

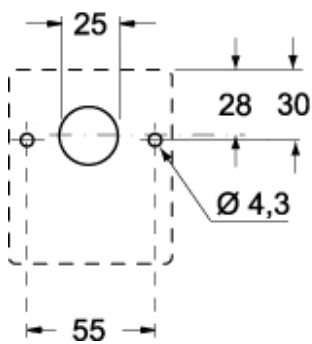
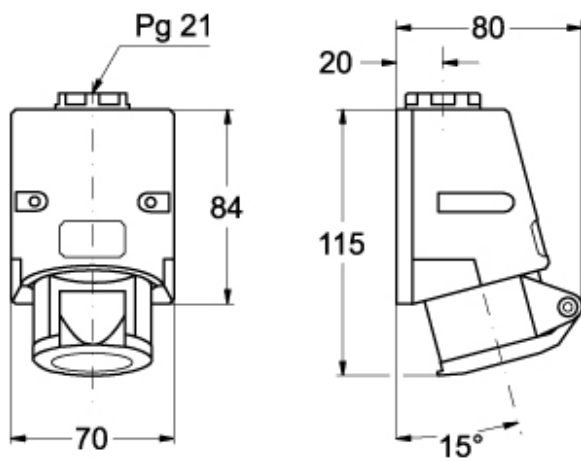

Notes