

Part number

MZPR 06 L20



Surface mounting housing, 180 °C series, with 1 lever, M20 cable entry, size "44.27"

Product description

Product type	Surface mounting housing
Series	180 °C
Closing type	With 1 lever
Size	Size 44.27
Cable entry	With cable entry M20

Technical data

IP degree of protection IP65

Further technical details

Weight	189,00 g
Operating temperature range (min, max)	-40°C ... +180°C

Material properties

RoHs conformity	Compliant
China RoHs - EFUP	E
REACH SVHC substances	No

Approvals / Standards

Certifications	DNV, BV
UL	ECBT2
cUL	ECBT8

General ordering information

EAN13 code	8015747104364
eCl@ss 8.1	27440202
ETIM 7.0	EC000437

Packaging Information

Packaging length	475,00 mm
Packaging height	160,00 mm
Packaging width	140,00 mm
Packaging weight	2,22 kg
Packaging volume	10,64 dm ³
Packaging description	Carton box
Packaging quantity	10 Pcs
Packaging EAN code	8015747250993
Sub-packaging weight	1,11 kg
Sub-packaging description	Plastic packaging
Sub-packaging quantity	5 Pcs
Sub-packaging EAN barcode	8015747105149

Part number

MZPR 06 L20



Catalogue drawings

CZIR L

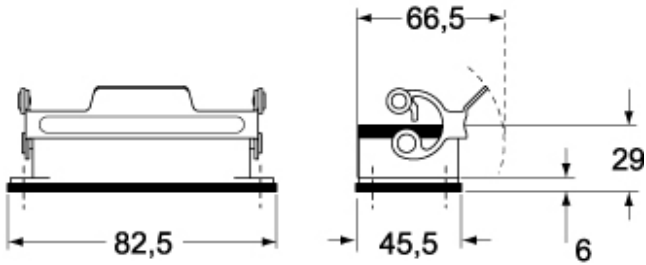

CZPR L CZAPR L - MZPR L MZAPR L

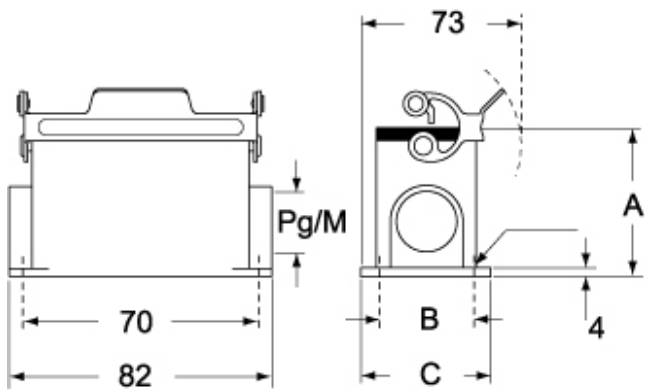

CHCR L

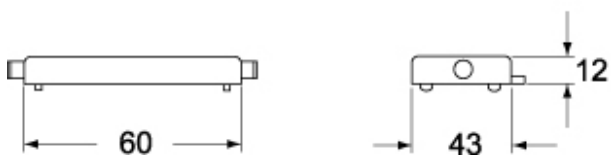

Notes