

Part number

MMAO 16 L32



Hood, 830V series, with 2 pegs, M32 side cable entry, size "104.27", high construction

Product description

| | |
|----------------------|-------------------------|
| Product type | Hood |
| Series | 830V |
| Closing type | With 2 pegs |
| Size | Size 104.27 |
| Cable entry | Side cable entry M32 |
| Specification | High construction |

Technical data

IP degree of protection IP65 / IP66 / IP69

Further technical details

| | |
|---|----------------|
| Weight | 259,00 g |
| Operating temperature range (min, max) | -40°C...+125°C |

Material properties

| | |
|------------------------------|---------------|
| Colour | RAL 7040 grey |
| RoHS conformity | Compliant |
| China RoHS - EFUP | E |
| REACH SVHC substances | No |

Approvals / Standards

| | |
|-----------------------|---------|
| Certifications | DNV, BV |
| UL | ECBT2 |
| cUL | ECBT8 |

General ordering information

EAN13 code 8015747057158

Packaging Information

| | |
|----------------------------------|-------------------|
| Sub-packaging weight | 1,30 kg |
| Sub-packaging description | Plastic packaging |
| Sub-packaging quantity | 5 Pcs |
| Sub-packaging EAN barcode | 8015747106122 |

Part number

MMAO 16 L32



Catalogue drawings

**CMO L (CMAO L) - MMO L [MMAO L]
CMV L [CMAV L] - MMV L (MMAV L)**

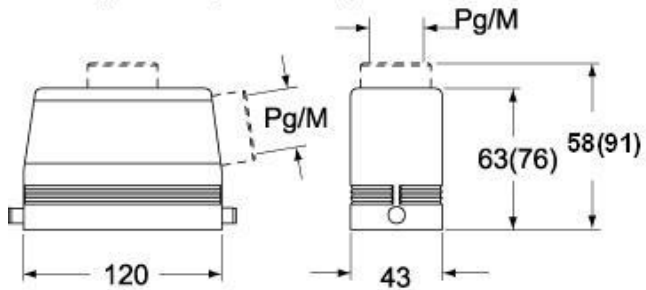

Catalogue drawings

**CMO L (CMAO L) - MMO L [MMAO L]
CMV L [CMAV L] - MMV L (MMAV L)**

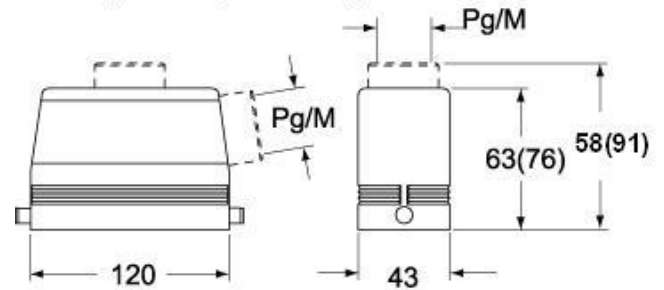

**CMV LG (CMAV LG) - MMV LG (MMAV LG)
[MMFV LG]**

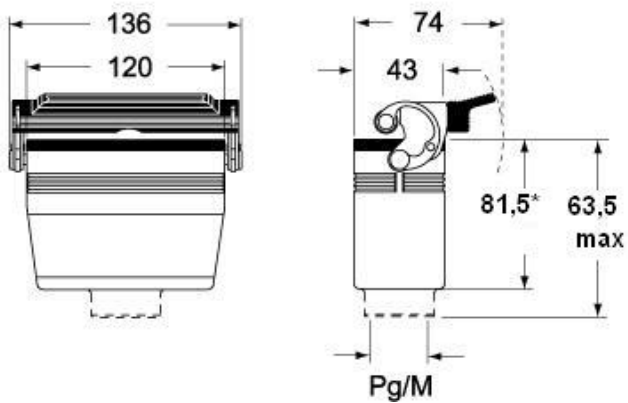

**CMV LG (CMAV LG) - MMV LG (MMAV LG)
[MMFV LG]**

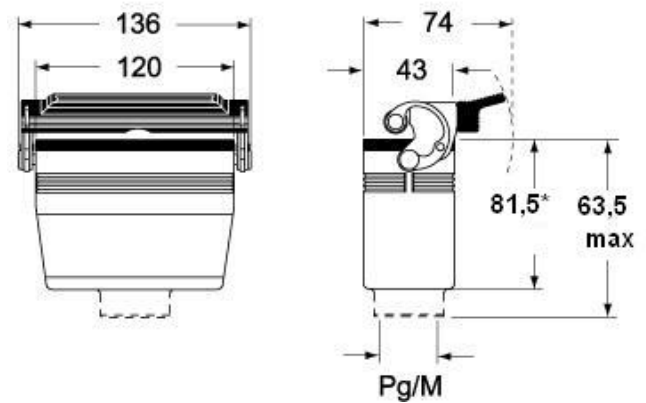

Notes