

Part number

MKH IAP25



Angled Bulkhead mounting housing, CKH series, with 1 lever, M25 cable entry, size "21.21", fixing by 4 screws

| Product description | | Material properties | |
|---|---|----------------------------------|--|
| Product type | Angled bulkhead mounting housing | Main material | Polyamide (PA) |
| Series | CKH | Other materials | Lever: Polypropylene (PP), metal-detectable Gasket: Silicone rubber |
| Closing type | With 1 lever | Colour | RAL 7012 grey, RAL 5005 blue |
| Size | Size "21.21" | RoHs conformity | Compliant |
| Cable entry | With cable entry M25 | China RoHs - EFUP | E |
| Specification | Fixing by 4 screws | REACH SVHC substances | No |
| Technical data | | General ordering information | |
| IP degree of protection | IP44 (IP66/IP67/IP69 with CKRH 65/CKRH 65 D kits) | EAN13 code | 8015747301749 |
| Further technical details | | eCl@ss 8.1 | 27440202 |
| Weight | 22,50 g | ETIM 7.0 | EC000437 |
| Operating temperature range (min, max) | -40°C...+70°C | Packaging Information | |
| | | Sub-packaging weight | 0,02 kg |
| | | Sub-packaging description | Plastic bag |
| | | Sub-packaging quantity | 1 Pcs |
| | | Sub-packaging EAN barcode | 8015747301794 |

Part number

MKH IAP25



Catalogue drawings

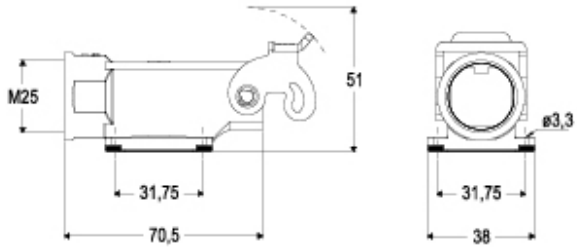

Notes