

Part number

MKAXXS AP25



Angled surface mounting housing, EMC series, with 1 lever, M25 cable entry, size "21.21"

Product description

Product type	Angled surface mounting housing
Series	EMC
Closing type	With 1 lever
Size	Size "21.21"
Cable entry	With cable entry M25

Technical data

IP degree of protection	IP44 - IP66 / IP67 / IP69 with CKR 65 (D)
--------------------------------	---

Further technical details

Operating temperature range (min, max)	-40°C...+125°C
---	----------------

Material properties

Main material	Zinc die-cast
Other materials	Lever: Stainless steel Gasket: Conductive elastomer
Colour	RAL 7040 grey
RoHs conformity	Compliant
China RoHs - EFUP	E
REACH SVHC substances	No

Approvals / Standards

Certifications	DNV, BV
UL	ECBT2
cUL	ECBT8

General ordering information

EAN13 code	8015747259866
eCl@ss 8.1	27440202
ETIM 7.0	EC000437

Part number

MKAXXS AP25



Catalogue drawings

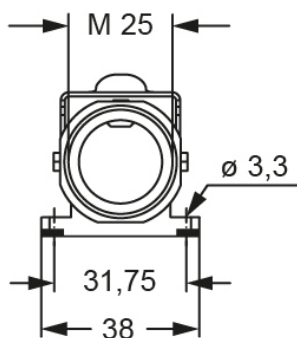
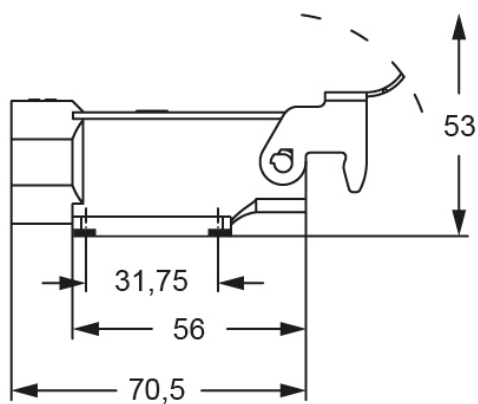

Catalogue drawings

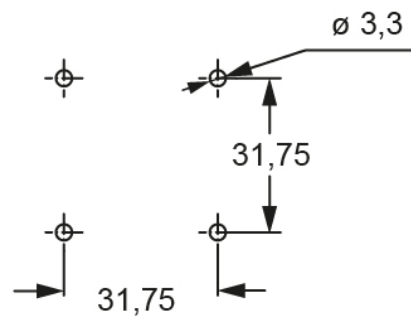

Notes