

Part number

MGVE 24.50



Hood, E-Xtreme® IP68 series, with 2 screws,
M50 top cable entry, size "104.27"

Product description

Product type	Hood
Series	E-Xtreme® IP68
Closing type	With 2 screws
Size	Size 104.27
Cable entry	Top cable entry M50

Technical data

IP degree of protection	IP66 / IP68 / IP69
--------------------------------	--------------------

Further technical details

Weight	5,00 g
Operating temperature range (min, max)	-40°C...+125°C

Material properties

Other materials	Screws: Stainless steel
Colour	RAL 7016 grey
RoHs conformity	Compliant
China RoHs - EFUP	E
REACH SVHC substances	No

Approvals / Standards

Certifications	DNV, BV
UL	ECBT2
cUL	ECBT8

General ordering information

EAN13 code	8015747254717
eCl@ss 8.1	27440202
ETIM 7.0	EC000437

Packaging Information

Packaging length	205,00 mm
Packaging height	135,00 mm
Packaging width	135,00 mm
Packaging volume	3,74 dm ³
Packaging description	Carton box
Packaging quantity	2 Pcs
Packaging EAN code	8015747183772
Sub-packaging description	Plastic packaging
Sub-packaging quantity	1 Pcs
Sub-packaging EAN barcode	8015747183789

Part number

MGVE 24.50



Catalogue drawings

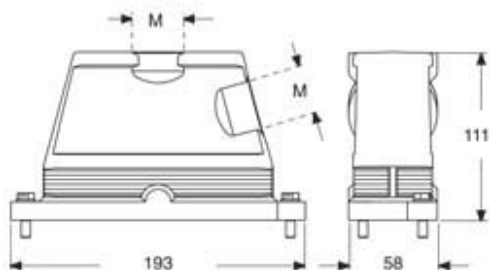

Notes