

Part number

MGVE 16.32



Hood, E-Xtreme® IP68 series, with 2 screws,
M32 top cable entry, size "77.27"

Product description

Product type	Hood
Series	E-Xtreme® IP68
Closing type	With 2 screws
Size	Size 77.27
Cable entry	Top cable entry M32

Technical data

IP degree of protection	IP66 / IP68 / IP69
--------------------------------	--------------------

Further technical details

Operating temperature range (min, max)	-40°C...+125°C
---	----------------

Material properties

Other materials	Screws: Stainless steel
Colour	RAL 7016 grey
RoHs conformity	Compliant
China RoHs - EFUP	E
REACH SVHC substances	No

Approvals / Standards

Certifications	DNV, BV
UL	ECBT2
cUL	ECBT8

General ordering information

EAN13 code	8015747254632
eCl@ss 8.1	27440202
ETIM 7.0	EC000437

Part number

MGVE 16.32



Catalogue drawings

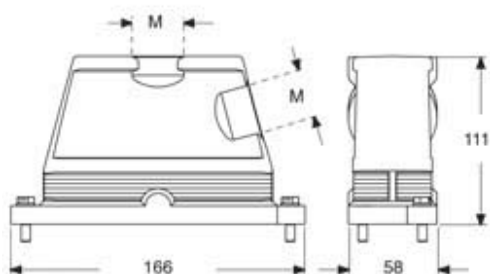

Notes