

Part number

# MGOE 16.40



Hood, E-Xtreme® IP68 series, with 2 screws,  
M40 side cable entry, size "77.27"

## Product description

<b>Product type</b>	Hood
<b>Series</b>	E-Xtreme® IP68
<b>Closing type</b>	With 2 screws
<b>Size</b>	Size 77.27
<b>Cable entry</b>	Side cable entry M40

## Technical data

<b>IP degree of protection</b>	IP66 / IP68 / IP69
--------------------------------	--------------------

## Further technical details

<b>Weight</b>	525,50 g
<b>Operating temperature range (min, max)</b>	-40°C...+125°C

## Material properties

<b>Other materials</b>	Screws: Stainless steel
<b>Colour</b>	RAL 7016 grey
<b>RoHs conformity</b>	Compliant
<b>China RoHs - EFUP</b>	E
<b>REACH SVHC substances</b>	No

## Approvals / Standards

<b>Certifications</b>	DNV, BV
<b>UL</b>	ECBT2
<b>cUL</b>	ECBT8

## General ordering information

<b>EAN13 code</b>	8015747253123
<b>eCl@ss 8.1</b>	27440202
<b>ETIM 7.0</b>	EC000437

## Packaging Information

<b>Packaging length</b>	175,00 mm
<b>Packaging height</b>	135,00 mm
<b>Packaging width</b>	130,00 mm
<b>Packaging weight</b>	1,13 kg
<b>Packaging volume</b>	3,07 dm <sup>3</sup>
<b>Packaging description</b>	Carton box
<b>Packaging quantity</b>	2 Pcs
<b>Packaging EAN code</b>	8015747253130
<b>Sub-packaging weight</b>	0,57 kg
<b>Sub-packaging description</b>	Plastic packaging
<b>Sub-packaging quantity</b>	1 Pcs
<b>Sub-packaging EAN barcode</b>	8015747253147

Part number

# MGOE 16.40



Catalogue drawings

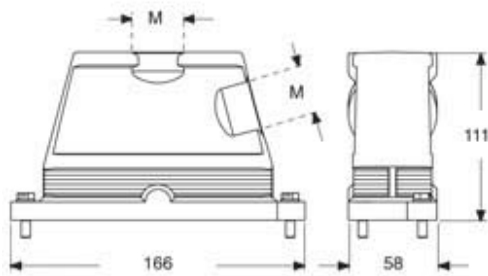

---

Notes