

Part number

MAVR 24.40



Hood, 180 °C series, with 4 pegs, M40 top cable entry, size "104.27", high construction

Product description

Product type	Hood
Series	180 °C
Closing type	With 4 pegs
Size	Size 104.27
Cable entry	Top cable entry M40
Specification	High construction

Technical data

IP degree of protection IP65 / IP66 / IP69

Further technical details

Weight	210,00 g
Operating temperature range (min, max)	-40°C ... +180°C

Material properties

RoHs conformity	Compliant
China RoHs - EFUP	E
REACH SVHC substances	No

Approvals / Standards

Certifications	DNV, BV
UL	ECBT2
cUL	ECBT8

General ordering information

EAN13 code	8015747115438
eCl@ss 8.1	27440202
ETIM 7.0	EC000437

Packaging Information

Sub-packaging weight	1,05 kg
Sub-packaging description	Plastic packaging
Sub-packaging quantity	5 Pcs
Sub-packaging EAN barcode	8015747115452

Part number

MAVR 24.40



Catalogue drawings

CHOR (CAOR) - MHOR (MAOR)

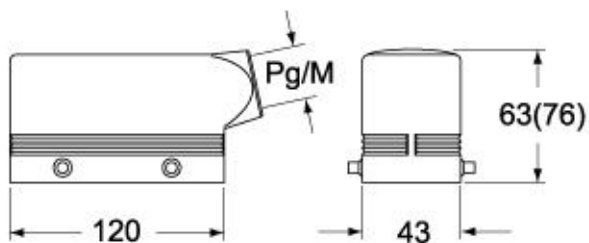

CHVR (CAVR) - MHVR (MAVR)

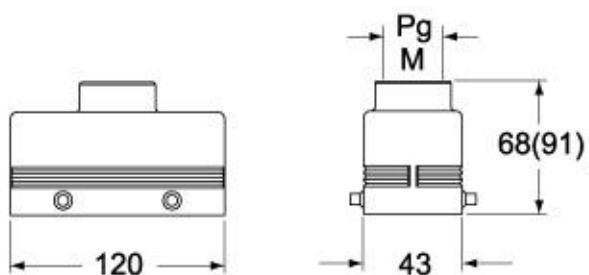

CHCR G

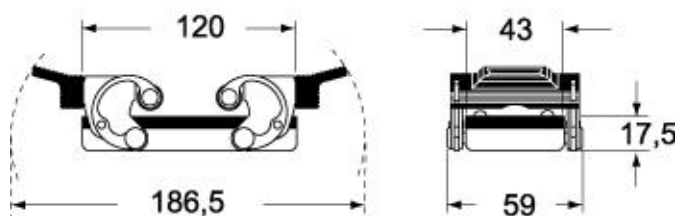

Notes