

Part number

# MAV 24 G32



Hood, C-TYPE series, with 2 levers, M32 top cable entry, size "104.27", high construction

<b>Product description</b>		<b>Material properties</b>	
<b>Product type</b>	Hood	<b>Other materials</b>	Lever: Stainless steel, polyamide (PA) Gasket: NBR
<b>Series</b>	C-TYPE	<b>Colour</b>	RAL 7040 grey
<b>Closing type</b>	With 2 levers	<b>RoHs conformity</b>	Compliant with exemption 6(c): copper alloy containing up to 4% lead by weight
<b>Size</b>	Size 104.27	<b>China RoHs - EFUP</b>	50
<b>Cable entry</b>	Top cable entry with adapter M32	<b>REACH SVHC substances</b>	Yes Lead
<b>Specification</b>	High construction	<b>SCIP number</b>	15deaf78-e939-4401-a0b0-e2228ca32a03
<b>Technical data</b>		<b>Approvals / Standards</b>	
<b>IP degree of protection</b>	IP65 / IP66 / IP69	<b>Certifications</b>	DNV, BV
<b>Further technical details</b>		<b>UL</b>	ECBT2
<b>Weight</b>	400,00 g	<b>cUL</b>	ECBT8
<b>Operating temperature range (min, max)</b>	-40°C...+125°C	<b>General ordering information</b>	
		<b>EAN13 code</b>	8015747052702
		<b>eCl@ss 8.1</b>	27440202
		<b>ETIM 7.0</b>	EC000437
		<b>Packaging Information</b>	
		<b>Packaging length</b>	475,00 mm
		<b>Packaging height</b>	220,00 mm
		<b>Packaging width</b>	200,00 mm
		<b>Packaging weight</b>	4,03 kg
		<b>Packaging volume</b>	20,90 dm <sup>3</sup>
		<b>Packaging description</b>	Carton box
		<b>Packaging quantity</b>	10 Pcs
		<b>Packaging EAN code</b>	8015747298049
		<b>Sub-packaging weight</b>	2,02 kg
		<b>Sub-packaging description</b>	Plastic packaging
		<b>Sub-packaging quantity</b>	5 Pcs
		<b>Sub-packaging EAN barcode</b>	8015747052719

Part number

# MAV 24 G32



Catalogue drawings

**CHO [CAO] CHV (CAV) - MHO [MAO]  
MHV (MAV)**

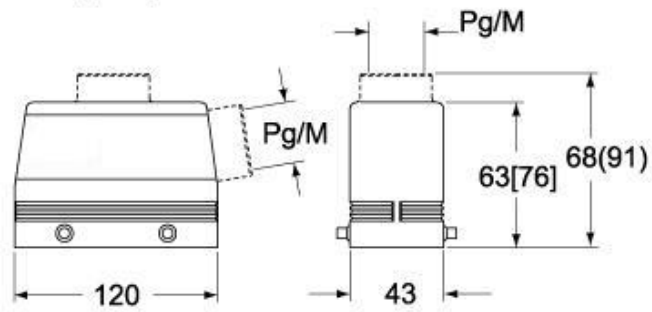

**CHV G (CAV G) - MHV G (MAV G) - [MFV G]**

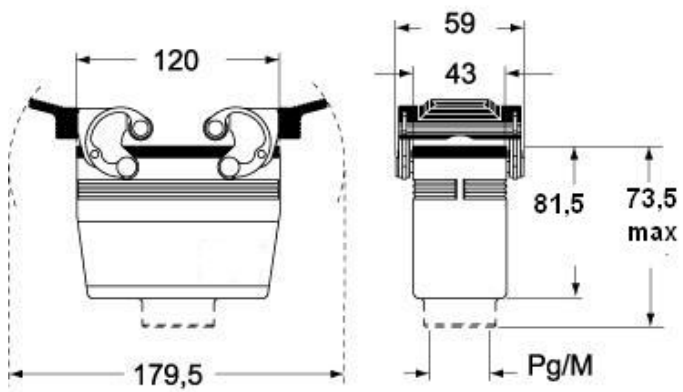

Notes