

Part number

# MAP 06 LS232



Surface mounting housing, C-TYPE series, with 1 lever, M32 x 2 cable entry, size "44.27", high construction, with metal cover

## Product description

|                      |                                     |
|----------------------|-------------------------------------|
| <b>Product type</b>  | Surface mounting housing            |
| <b>Series</b>        | C-TYPE                              |
| <b>Closing type</b>  | With 1 lever                        |
| <b>Size</b>          | Size 44.27                          |
| <b>Cable entry</b>   | With cable entry<br>M32 x 2         |
| <b>Specification</b> | High construction, with metal cover |

## Technical data

**IP degree of protection** IP65

## Further technical details

|   |                |
|---|----------------|
| <b>Weight</b>                                 | 287,00 g       |
| <b>Operating temperature range (min, max)</b> | -40°C...+125°C |

## Material properties

|                              |   |
|------------------------------|---|
| <b>Other materials</b>       | Lever: Stainless steel, polyamide (PA)<br>Gasket: NBR |
| <b>Colour</b>                | RAL 7040 grey   |
| <b>RoHs conformity</b>       | Compliant   |
| <b>China RoHs - EFUP</b>     | E   |
| <b>REACH SVHC substances</b> | No  |

## Approvals / Standards

|                       |         |
|-----------------------|---------|
| <b>Certifications</b> | DNV, BV |
| <b>UL</b>             | ECBT2   |
| <b>cUL</b>            | ECBT8   |

## General ordering information

|                   |               |
|-------------------|---------------|
| <b>EAN13 code</b> | 8015747050968 |
| <b>eCl@ss 8.1</b> | 27440202      |
| <b>ETIM 7.0</b>   | EC000437      |

## Packaging Information

|                                  |                       |
|----------------------------------|-----------------------|
| <b>Packaging length</b>          | 475,00 mm             |
| <b>Packaging height</b>          | 200,00 mm             |
| <b>Packaging width</b>           | 150,00 mm             |
| <b>Packaging weight</b>          | 3,70 kg               |
| <b>Packaging volume</b>          | 14,25 dm <sup>3</sup> |
| <b>Packaging description</b>     | Carton box            |
| <b>Packaging quantity</b>        | 10 Pcs                |
| <b>Packaging EAN code</b>        | 8015747239448         |
| <b>Sub-packaging weight</b>      | 1,85 kg               |
| <b>Sub-packaging description</b> | Plastic packaging     |
| <b>Sub-packaging quantity</b>    | 5 Pcs                 |
| <b>Sub-packaging EAN barcode</b> | 8015747050975         |

Part number

# MAP 06 LS232



Catalogue drawings

## CHP L CAP L - MHP L MAP L

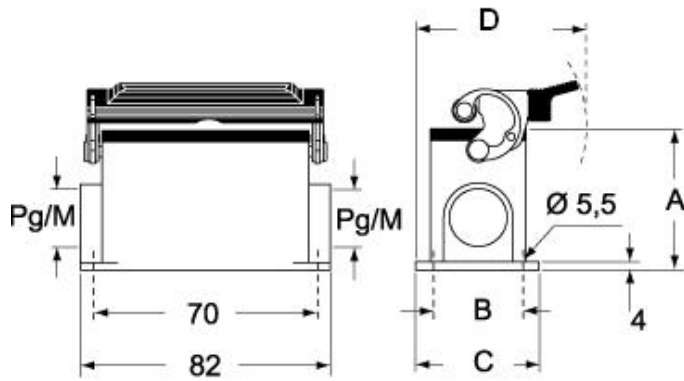

## CHP LS CAP LS - MHP LS MAP LS

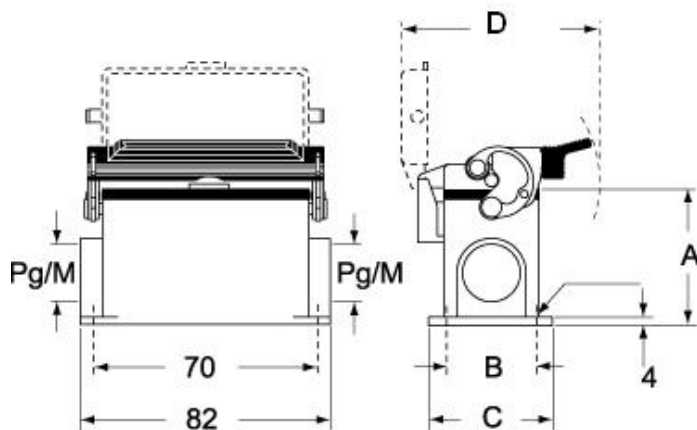

---

Notes