

Part number

M7APE 16.232



Surface mounting housing, E-Xtreme® V-TYPE series, with 2 levers, M32 x 2 cable entry, size "77.27", high construction

Product description		Material properties	
Product type	Surface mounting housing	Other materials	Lever: Stainless steel Gasket: FKM
Series	E-Xtreme® V-TYPE	Colour	RAL 7016 grey
Closing type	With 2 levers	RoHS conformity	Compliant
Size	Size 77.27	China RoHS - EFUP	E
Cable entry	With cable entry M32 x 2	REACH SVHC substances	No
Specification	High construction	Approvals / Standards	
Technical data		Certifications	DNV, BV
IP degree of protection	IP66 / IP67 / IP69	UL	ECBT2
Further technical details		cUL	ECBT8
Weight	420,00 g	General ordering information	
Operating temperature range (min, max)	-40°C...+125°C	EAN13 code	8015747254151
		eCl@ss 8.1	27440202
		ETIM 7.0	EC000437
		Packaging Information	
		Packaging length	475,00 mm
		Packaging height	220,00 mm
		Packaging width	175,00 mm
		Packaging weight	4,30 kg
		Packaging volume	18,29 dm³
		Packaging description	Carton box
		Packaging quantity	10 Pcs
		Packaging EAN code	8015747282246
		Sub-packaging weight	2,15 kg
		Sub-packaging description	Plastic packaging
		Sub-packaging quantity	5 Pcs
		Sub-packaging EAN barcode	8015747282253

Part number

M7APE 16.232



Catalogue drawings

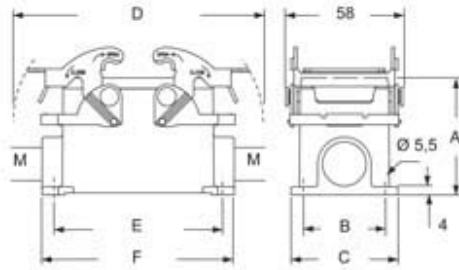

type	A	B	C	D	E	F
M7PE 16	63	45	57	142,5	105	117
M7APE 16	77	45	57	142,5	105	117

Notes