

Part number

# JMPP 16 L225



Surface mounting housing, JEI®-P series, with 1 lever, M25 x 2 cable entry, size 77.27

#### Product description

<b>Product type</b>	Surface mounting housing
<b>Series</b>	JEI®-P
<b>Closing type</b>	With 1 lever
<b>Size</b>	Size 77.27
<b>Cable entry</b>	With cable entry M25 x 2

#### Technical data

**IP degree of protection** IP65

#### Further technical details

**Operating temperature range (min, max)** -40°C...+125°C

#### Material properties

<b>Other materials</b>	Lever: Polyamide (PA) Gasket: NBR
<b>Colour</b>	RAL 7040 grey

#### General ordering information

**EAN13 code** 8015747034425

Part number

# JMPP 16 L225



Catalogue drawings

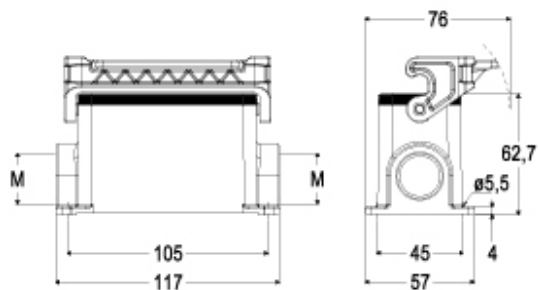

---

Notes