

Part number

CZP 15 L2



Surface mounting housing, IL-BRID series, with 1 lever, Pg16 x 2 cable entry, size "49.16"

Product description		Material properties	
Product type	Surface mounting housing	Other materials	Lever: Polyamide (PA) and Stainless steel core
Series	IL-BRID	Colour	RAL 7040 grey
Closing type	With 1 lever	RoHs conformity	Compliant
Size	Size 49.16	China RoHs - EFUP	E
Cable entry	With cable entry Pg16 x 2	REACH SVHC substances	No
Technical data		Approvals / Standards	
IP degree of protection	IP65 / IP66 / IP69	UL	ECBT2
Further technical details		cUL	ECBT8
Further technical details		General ordering information	
Weight	150,00 g	EAN13 code	8015747044653
Operating temperature range (min, max)	-40°C...+125°C	Packaging Information	
		Packaging length	270,00 mm
		Packaging height	130,00 mm
		Packaging width	135,00 mm
		Packaging weight	1,67 kg
		Packaging volume	4,74 dm ³
		Packaging description	Carton box
		Packaging quantity	10 Pcs
		Packaging EAN code	8015747171960
		Sub-packaging weight	0,84 kg
		Sub-packaging description	Plastic packaging
		Sub-packaging quantity	5 Pcs
		Sub-packaging EAN barcode	8015747171977

Part number

CZP 15 L2



Catalogue drawings

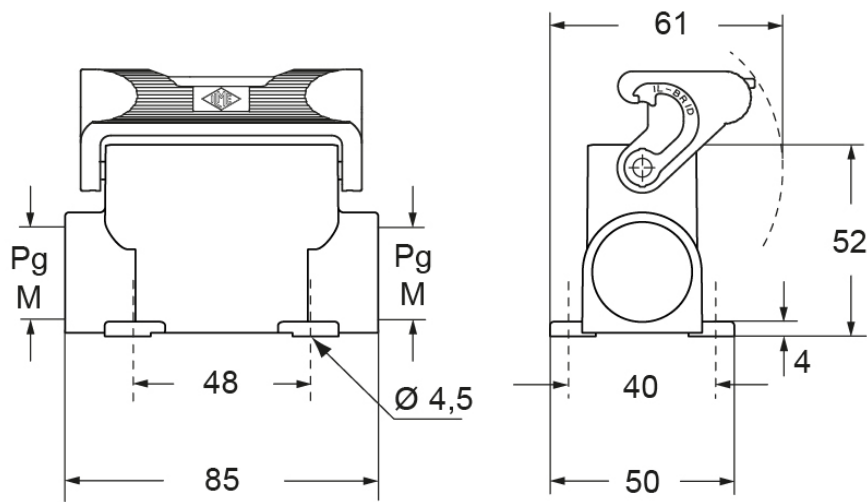

Notes