

Part number

# CHO 06 LX16



Hood, C-TYPE series, with 1 lever, Pg16 side cable entry, size "44.27", without gasket

## Product description

<b>Product type</b>	Hood
<b>Series</b>	C-TYPE
<b>Closing type</b>	With 1 lever
<b>Size</b>	Size 44.27
<b>Cable entry</b>	Side cable entry Pg16
<b>Specification</b>	Without gasket

## Technical data

<b>IP degree of protection</b>	IP65 / IP66 / IP69
--------------------------------	--------------------

## Further technical details

<b>Weight</b>	149,00 g
<b>Operating temperature range (min, max)</b>	-40°C...+125°C

## Material properties

<b>Other materials</b>	Lever: Stainless steel, polyamide (PA)
<b>Colour</b>	RAL 7040 grey
<b>RoHs conformity</b>	Compliant
<b>China RoHs - EFUP</b>	E
<b>REACH SVHC substances</b>	No

## Approvals / Standards

<b>Certifications</b>	DNV, BV
<b>UL</b>	ECBT2
<b>cUL</b>	ECBT8

## General ordering information

<b>EAN13 code</b>	8015747019767
-------------------	---------------

## Packaging Information

<b>Sub-packaging weight</b>	0,75 kg
<b>Sub-packaging description</b>	Carton box
<b>Sub-packaging quantity</b>	5 Pcs
<b>Sub-packaging EAN barcode</b>	8015747019774

Part number

# CHO 06 LX16



Catalogue drawings

## CHO LX CHV LX - MHO LX MHV LX

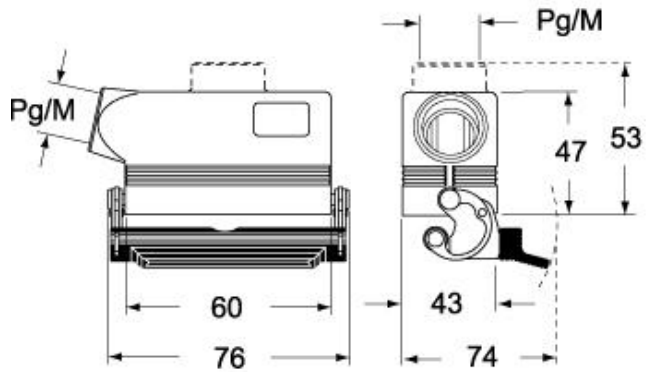

## CHV LG (CAV LG), MHV LG (MAV LG) [MFV LG]

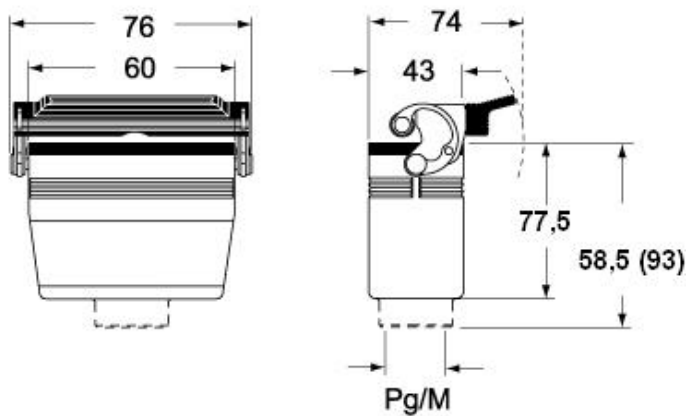

## CHO L (CAO L) - MHO (MAO/MFO/MFV L) MHV L [MAV L]

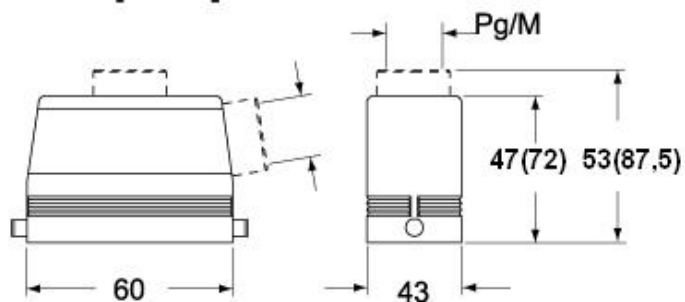

Notes