

Part number

# CAF 24.221



Hood, C-TYPE series, with 4 pegs, Pg21 x 2 double frontal cable entry, size "104.27", high construction

#### Product description

|                      |  |
|----------------------|--|
| <b>Product type</b>  | Hood   |
| <b>Series</b>        | C-TYPE   |
| <b>Closing type</b>  | With 4 pegs                                      |
| <b>Size</b>          | Size 104.27                                      |
| <b>Cable entry</b>   | Double frontal cable entry with adapter Pg21 x 2 |
| <b>Specification</b> | High construction                                |

#### Technical data

**IP degree of protection** IP65 / IP66 / IP69

#### Further technical details

|   |                |
|---|----------------|
| <b>Weight</b>                                 | 333,00 g       |
| <b>Operating temperature range (min, max)</b> | -40°C...+125°C |

#### Material properties

|                              |  |
|------------------------------|--|
| <b>Colour</b>                | RAL 7040 grey  |
| <b>RoHs conformity</b>       | Compliant with exemption 6(c): copper alloy containing up to 4% lead by weight |
| <b>China RoHs - EFUP</b>     | 50   |
| <b>REACH SVHC substances</b> | Yes<br>Lead  |
| <b>SCIP number</b>           | 15deaf78-e939-4401-a0b0-e2228ca32a03   |

#### Approvals / Standards

|                       |         |
|-----------------------|---------|
| <b>Certifications</b> | DNV, BV |
| <b>UL</b>             | ECBT2   |
| <b>cUL</b>            | ECBT8   |

#### General ordering information

**EAN13 code** 8015747005982

#### Packaging Information

|                                  |                   |
|----------------------------------|-------------------|
| <b>Sub-packaging weight</b>      | 0,33 kg           |
| <b>Sub-packaging description</b> | Plastic packaging |
| <b>Sub-packaging quantity</b>    | 1 Pcs             |
| <b>Sub-packaging EAN barcode</b> | 8015747005999     |

Part number

# CAF 24.221



Catalogue drawings

CAF - MAF/MFF

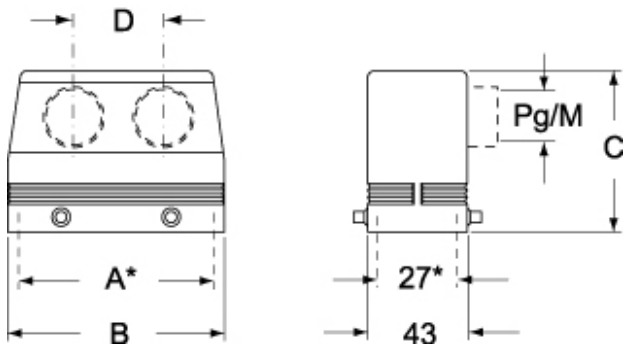

Notes