

Part number

TM 3245 IR



Interlocked switched socket-outlet, TM series, 3 poles + N + PE, 4 h (yellow), 32 A, 57/100 ÷ 75/130 V, with compartment for modular units, 6 DIN-rail modules EN 60715, with base box

Product description

Product type	Interlocked switched socket-outlet
Series	TM..IR/KIR
N. of poles	3 poles + N + 
Clock position	4
Size	145 x 565 x 18 mm
Specification	With compartment for modular units, 6 DIN-rail modules EN 60715 With base box

Technical data

Current	32 A
Voltage	57/100 ÷ 75/130 V
IP degree of protection	IP66 / IP67

Further technical details

Weight	3.010,00 g
Operating temperature range (min, max)	-25°C ... +40°C
UL 94 flammability rating	V-2
IK rating (impact degree of protection)	IK10

Material properties

Colour	RAL 7012 grey, RAL 1021 yellow
---------------	--------------------------------

Approvals / Standards

Reference standard	EN 60309-1, -2 e -4
---------------------------	---------------------

General ordering information

EAN13 code	8015747091794
-------------------	---------------

Packaging Information

Sub-packaging weight	3,01 kg
Sub-packaging description	Carton box
Sub-packaging quantity	1 Pcs
Sub-packaging EAN barcode	8015747107495

Part number

TM 3245 IR



Catalogue drawings

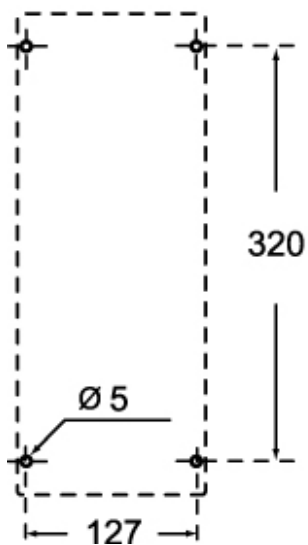
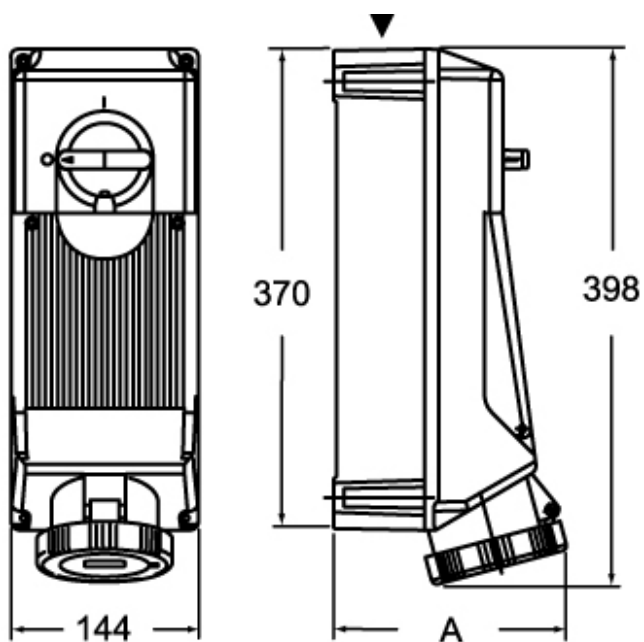

	A
2P+⊕	162
3P+⊕	162
3P+N+⊕	169