

Part number

PEW 6363 SV



Mobile plug, PLUSO series, 2 poles + PE, 6 h (blue), 63 A, 200 ÷ 250 V, straight

| Product description | | Material properties | |
|---|---|------------------------------|---|
| Product type | Plug Mobile | Colour | RAL 7035 grey, RAL 5015 blue |
| Series | PEW...SV, PLUSO | RoHs conformity | Compliant with exemption 6(c): copper alloy containing up to 4% lead by weight |
| N. of poles | 2 poles +  | China RoHs - EFUP | 50 |
| Clock position | 6 | REACH SVHC substances | Yes Lead |
| Specification | Straight | SCIP number | Ca7de37f-add8-4b77-9861-279c94903ade |
| Technical data | | Approvals / Standards | |
| Current | 63 A | Reference standard | EN 60309-1 and -2 |
| Voltage | 200 ÷ 250 V | General ordering information | |
| IP degree of protection | IP67 | EAN13 code | 8015747077422 |
| Further technical details | | Packaging Information | |
| Weight | 705,00 g | Packaging weight | 1,55 kg |
| Operating temperature range (min, max) | -25°C ... +40°C | Packaging volume | 6,61 dm ³ |
| | | Packaging description | Carton box |
| | | Packaging quantity | 2 Pcs |
| | | Packaging EAN code | 8015747077439 |

Part number

PEW 6363 SV



Catalogue drawings

(63 / 125A) PEW ... SV

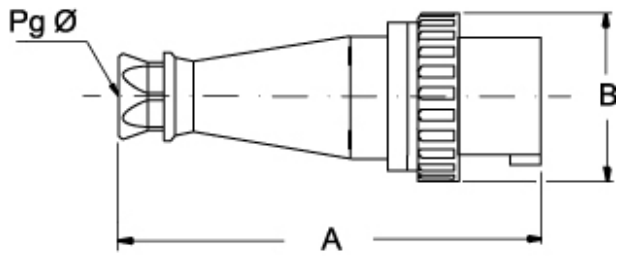

| PEW ... SV | A | B | Pg Ø |
|------------------|-------|-----|--------|
| 63A 2P+⊕ | 264,5 | 112 | 36 |
| 3P+⊕ | 264,5 | 112 | 36 |
| 3P+N+⊕ | 264,5 | 112 | 36 |
| 125A 2P+⊕ | 310 | 130 | 2" gas |
| 3P+⊕ | 310 | 130 | 2" gas |
| 3P+N+⊕ | 310 | 130 | 2" gas |