

Part number

PEW 6355 PQ



Flush-mounting socket outlet, PLUSO series, 3 poles + N + PE, 5 h (black), 63 A, 347/600 ÷ 400/690 V, straight

Product description

Product type	Socket Flush-mounting
Series	PEW...PQ, PLUSO
N. of poles	3 poles + N + 
Clock position	5
Specification	Straight

Technical data

Current	63 A
Voltage	347/600 ÷ 400/690 V
IP degree of protection	IP67

Further technical details

Operating temperature range (min, max)	-25°C ... +40°C
---	-----------------

Material properties

Colour	RAL 7035 grey, RAL 9005 black
---------------	-------------------------------

Approvals / Standards

Reference standard	EN 60309-1 and -2
---------------------------	-------------------

General ordering information

EAN13 code	8015747158350
-------------------	---------------

Part number

PEW 6355 PQ



Catalogue drawings

(63 / 125A) PEW ... PQ

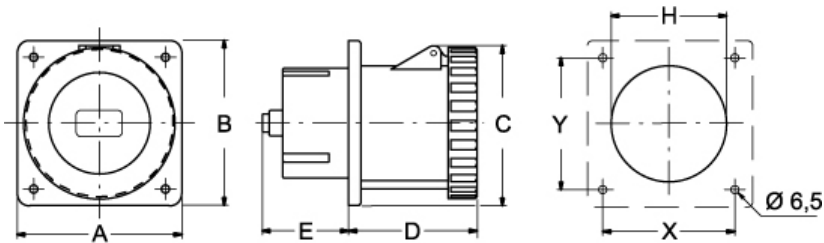

PEW ... PQ	A	B	C	D	E	H	X	Y
63A 2P+⊕	100	107	109	92	30	73	77	85
3P+⊕	100	107	109	92	30	73	77	85
3P+N+⊕	100	107	109	92	30	73	77	85
125A 2P+⊕	130	130	130	101	68	91	104	104
3P+⊕	130	130	130	101	68	91	104	104
3P+N+⊕	130	130	130	101	68	91	104	104