

Part number

# PE 1643 SI



Flush-mounting plug, PLUSO series, 2 poles + PE, 4 h (yellow), 16 A, 100 ÷ 130 V

Product description		Material properties	
<b>Product type</b>	Plug Flush-mounting	<b>Colour</b>	RAL 7035 grey, RAL 1021 yellow
<b>Series</b>	PE...SI, PLUSO	<b>RoHs conformity</b>	Compliant with exemption 6(c): copper alloy containing up to 4% lead by weight
<b>N. of poles</b>	2 poles +	<b>China RoHs - EFUP</b>	50
<b>Clock position</b>	4	<b>REACH SVHC substances</b>	Yes Lead
<b>Size</b>	Fixing centre distance socket 52 x 60 mm	<b>SCIP number</b>	Ca7de37f-add8-4b77-9861-279c94903ade
Technical data		Approvals / Standards	
<b>Current</b>	16 A	<b>Reference standard</b>	EN 60309-1 and -2
<b>Voltage</b>	100 ÷ 130 V	General ordering information	
<b>IP degree of protection</b>	IP44	<b>EAN13 code</b>	8015747063852
Further technical details		Packaging Information	
<b>Weight</b>	132,00 g	<b>Packaging length</b>	208,00 mm
<b>Operating temperature range (min, max)</b>	-25°C ... +40°C	<b>Packaging height</b>	140,00 mm
		<b>Packaging width</b>	290,00 mm
		<b>Packaging weight</b>	1,47 kg
		<b>Packaging volume</b>	8,44 dm <sup>3</sup>
		<b>Packaging description</b>	Carton box
		<b>Packaging quantity</b>	10 Pcs
		<b>Packaging EAN code</b>	8015747063869

Part number

# PE 1643 SI



Catalogue drawings

(16 / 32A) PE ... SI

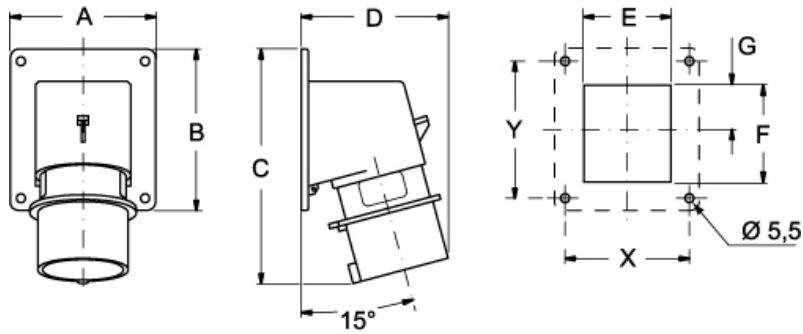

PE ... SI	A	B	C	D	E	F	G	X	Y
<b>16A</b> 2P+⊕	65	82	126	81	41	43	21,5	52	60
	65	82	126	81	47	43	21,5	52	60
	90	100	146	93	54	60	27,5	77	85
<b>32A</b> 2P+⊕	90	100	160	101	55	60	27,5	77	85
	90	100	160	101	55	60	27,5	77	85
	90	100	160	106	62	60	27,5	77	85