

Part number

MAPS 10.32



Surface mounting housing, EMC series, with 2 levers, M32 cable entry, size "57.27", high construction

Product description

| | |
|----------------------|--------------------------|
| Product type | Surface mounting housing |
| Series | EMC |
| Closing type | With 2 levers |
| Size | Size 57.27 |
| Cable entry | With cable entry M32 |
| Specification | High construction |

Technical data

| | |
|--------------------------------|--------------------|
| IP degree of protection | IP65 / IP66 / IP69 |
|--------------------------------|--------------------|

Further technical details

| | |
|---|----------------|
| Weight | 380,00 g |
| Operating temperature range (min, max) | -40°C...+125°C |

Material properties

| | |
|------------------------------|--|
| Other materials | Lever: Stainless steel, polyamide (PA) Gasket: Conductive elastomer |
| RoHs conformity | Compliant |
| China RoHs - EFUP | E |
| REACH SVHC substances | No |

Approvals / Standards

| | |
|-----------------------|---------|
| Certifications | DNV, BV |
| UL | ECBT2 |
| cUL | ECBT8 |

General ordering information

| | |
|-------------------|---------------|
| EAN13 code | 8015747125024 |
| eCl@ss 8.1 | 27440202 |
| ETIM 7.0 | EC000437 |

Packaging Information

| | |
|----------------------------------|-----------------------|
| Packaging length | 475,00 mm |
| Packaging height | 200,00 mm |
| Packaging width | 150,00 mm |
| Packaging weight | 4,10 kg |
| Packaging volume | 14,25 dm ³ |
| Packaging description | Carton box |
| Packaging quantity | 10 Pcs |
| Packaging EAN code | 8015747249188 |
| Sub-packaging weight | 2,05 kg |
| Sub-packaging description | Plastic packaging |
| Sub-packaging quantity | 5 Pcs |
| Sub-packaging EAN barcode | 8015747249195 |

Part number

MAPS 10.32



Catalogue drawings

CHIS

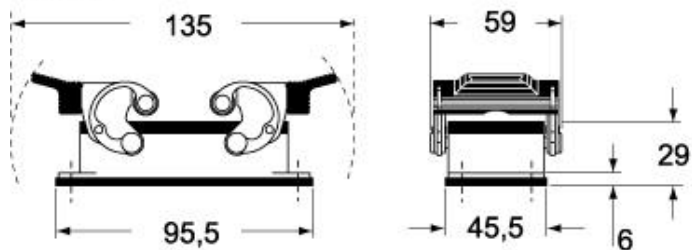

CAPS - MAPS

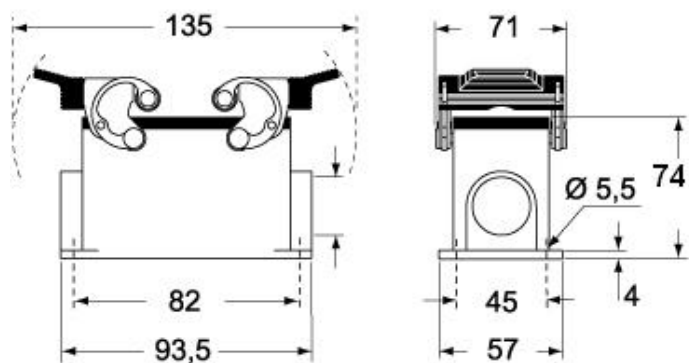

CHCS

