

Part number

MAPR 16.32



Surface mounting housing, 180 °C series, with 2 levers, M32 cable entry, size "77.27", high construction

Product description

| | |
|----------------------|--------------------------|
| Product type | Surface mounting housing |
| Series | 180 °C |
| Closing type | With 2 levers |
| Size | Size 77.27 |
| Cable entry | With cable entry M32 |
| Specification | High construction |

Technical data

IP degree of protection IP65

Further technical details

| | |
|---|------------------|
| Weight | 400,00 g |
| Operating temperature range (min, max) | -40°C ... +180°C |

Material properties

| | |
|------------------------------|-----------|
| RoHS conformity | Compliant |
| China RoHS - EFUP | E |
| REACH SVHC substances | No |
| Approvals / Standards | |
| Certifications | DNV, BV |
| UL | ECBT2 |
| cUL | ECBT8 |

General ordering information

| | |
|-------------------|---------------|
| EAN13 code | 8015747101158 |
| eCl@ss 8.1 | 27440202 |
| ETIM 7.0 | EC000437 |

Packaging Information

| | |
|----------------------------------|-----------------------|
| Packaging length | 475,00 mm |
| Packaging height | 220,00 mm |
| Packaging width | 175,00 mm |
| Packaging weight | 5,49 kg |
| Packaging volume | 18,29 dm ³ |
| Packaging description | Carton box |
| Packaging quantity | 10 Pcs |
| Packaging EAN code | 8015747248327 |
| Sub-packaging weight | 2,75 kg |
| Sub-packaging description | Plastic packaging |
| Sub-packaging quantity | 5 Pcs |
| Sub-packaging EAN barcode | 8015747101349 |

Part number

MAPR 16.32



Catalogue drawings

CHIR

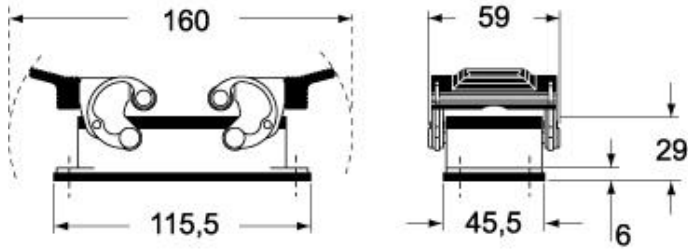

CAPR - MAPR

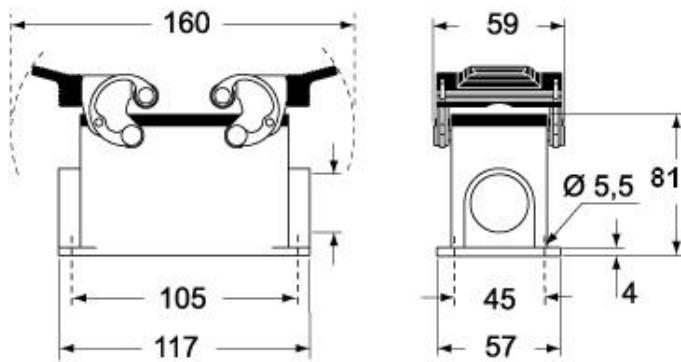

CHCR

