

Part number

# M7APE 06 L40



Surface mounting housing, E-Xtreme® V-TYPE series, with 1 lever, M40 cable entry, size "44.27", high construction

#### Product description

|                      |                          |
|----------------------|--------------------------|
| <b>Product type</b>  | Surface mounting housing |
| <b>Series</b>        | E-Xtreme® V-TYPE         |
| <b>Closing type</b>  | With 1 lever             |
| <b>Size</b>          | Size 44.27               |
| <b>Cable entry</b>   | With cable entry<br>M40  |
| <b>Specification</b> | High construction        |

#### Technical data

**IP degree of protection** IP66 / IP67 / IP69

#### Further technical details

|   |                |
|---|----------------|
| <b>Weight</b>                                 | 601,00 g       |
| <b>Operating temperature range (min, max)</b> | -40°C...+125°C |

#### Material properties

|                              |                                       |
|------------------------------|---------------------------------------|
| <b>Other materials</b>       | Lever: Stainless steel<br>Gasket: FKM |
| <b>Colour</b>                | RAL 7016 grey                         |
| <b>RoHS conformity</b>       | Compliant                             |
| <b>China RoHS - EFUP</b>     | E                                     |
| <b>REACH SVHC substances</b> | No                                    |

#### Approvals / Standards

|                       |         |
|-----------------------|---------|
| <b>Certifications</b> | DNV, BV |
| <b>UL</b>             | ECBT2   |
| <b>cUL</b>            | ECBT8   |

#### General ordering information

|                   |               |
|-------------------|---------------|
| <b>EAN13 code</b> | 8015747254083 |
| <b>eCl@ss 8.1</b> | 27440202      |
| <b>ETIM 7.0</b>   | EC000437      |

#### Packaging Information

|                                  |                      |
|----------------------------------|----------------------|
| <b>Packaging length</b>          | 300,00 mm            |
| <b>Packaging height</b>          | 160,00 mm            |
| <b>Packaging width</b>           | 180,00 mm            |
| <b>Packaging weight</b>          | 6,02 kg              |
| <b>Packaging volume</b>          | 8,64 dm <sup>3</sup> |
| <b>Packaging description</b>     | Carton box           |
| <b>Packaging quantity</b>        | 10 Pcs               |
| <b>Packaging EAN code</b>        | 8015747266468        |
| <b>Sub-packaging weight</b>      | 3,01 kg              |
| <b>Sub-packaging description</b> | Plastic packaging    |
| <b>Sub-packaging quantity</b>    | 5 Pcs                |
| <b>Sub-packaging EAN barcode</b> | 8015747266369        |

Part number

# M7APE 06 L40



## Catalogue drawings

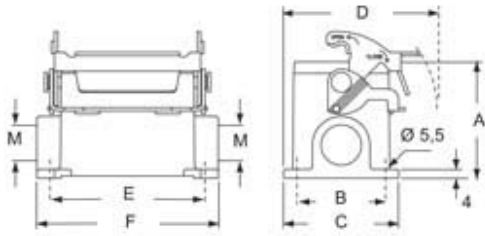

| type       | A  | B  | C  | D    | E  | F  |
|------------|----|----|----|------|----|----|
| M7PE 06 L  | 53 | 40 | 52 | 70   | 70 | 82 |
| M7APE 06 L | 73 | 45 | 57 | 72,5 | 70 | 82 |