

Part number

# FM 1043 CO



Collar for 1043 format box system, FM series

Product description	
<b>Product type</b>	Collar for 1043 format box system
<b>Series</b>	FM
Further technical details	
<b>Weight</b>	1,00 g
<b>Operating temperature range (min, max)</b>	-40°C ... +125°C

Material properties	
<b>Colour</b>	RAL 7035 grey
General ordering information	
<b>EAN13 code</b>	8015747047043
Packaging Information	
<b>Packaging description</b>	Carton box
<b>Packaging quantity</b>	10 Pcs
<b>Packaging EAN code</b>	8015747047050
<b>Sub-packaging description</b>	Plastic bag
<b>Sub-packaging quantity</b>	1 Pcs
<b>Sub-packaging EAN barcode</b>	8015747047067



Catalogue drawings

FM complementary parts and accessories



Box system carrying handle  
Climbing irons for box fixing



DIN-rail EN 60715 - Insulated terminal block  
Collar - Screws kit - Adhesive label



Description	Part No.	Part No.
<b>Box system carrying handle</b> - For 3236, 2451, 3251, 3221 and 4272 boards	FM 32 MT	
<b>Climbing irons for external wall mounting</b> - For 3236, 2451, 3251, 3221 and 4272 boards	BC SFT	
<b>Sized DIN-rail EN 60715 (35 mm)</b> With back plates for the positioning at different depths and fixing screws - For 2451 boards - For 3236, 3251, 3221 boards - For 4272 boards		FM GD 18 FM GD 25 FM GD 35
<b>Insulated terminal block, 3 P 25 mm<sup>2</sup> + 10 P 10 mm<sup>2</sup></b> - For neutral and/or ground, compliant with EN 60998-2-1, stackable (up to 2 units)		FM 2510 MI
<b>collar</b> - for format 1043 box system		FM 1043 CO
<b>screws kit</b> - for mounting sockets PQ-PI-PQF-PIF series		FM 416
<b>adhesive label</b> - for the identification of the mounted modular devices		FM 18 ET

Dimensions in mm

FM 32 MT

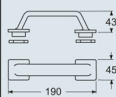

BC SFT

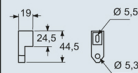

Dimensions in mm

FM GDxx

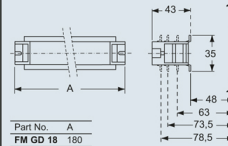

FM 2510 MI

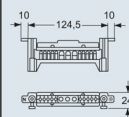

Dimensions indicated are not binding and may be changed without prior notice.