

Part number

# CHP 06 L2



Surface mounting housing, C-TYPE series, with 1 lever, Pg16 x 2 cable entry, size "44.27"

#### Product description

|                     |                              |
|---------------------|------------------------------|
| <b>Product type</b> | Surface mounting housing     |
| <b>Series</b>       | C-TYPE                       |
| <b>Closing type</b> | With 1 lever                 |
| <b>Size</b>         | Size 44.27                   |
| <b>Cable entry</b>  | With cable entry<br>Pg16 x 2 |

#### Technical data

**IP degree of protection** IP65

#### Further technical details

**Weight** 200,00 g

**Operating temperature range (min, max)** -40°C...+125°C

#### Material properties

|                              |   |
|------------------------------|---|
| <b>Other materials</b>       | Lever: Stainless steel, polyamide (PA)<br>Gasket: NBR |
| <b>Colour</b>                | RAL 7040 grey   |
| <b>RoHs conformity</b>       | Compliant   |
| <b>China RoHs - EFUP</b>     | E   |
| <b>REACH SVHC substances</b> | No  |

#### Approvals / Standards

|                       |         |
|-----------------------|---------|
| <b>Certifications</b> | DNV, BV |
| <b>UL</b>             | ECBT2   |
| <b>cUL</b>            | ECBT8   |

#### General ordering information

**EAN13 code** 8015747021487

#### Packaging Information

|                                  |                       |
|----------------------------------|-----------------------|
| <b>Packaging length</b>          | 475,00 mm             |
| <b>Packaging height</b>          | 160,00 mm             |
| <b>Packaging width</b>           | 140,00 mm             |
| <b>Packaging weight</b>          | 2,15 kg               |
| <b>Packaging volume</b>          | 10,64 dm <sup>3</sup> |
| <b>Packaging description</b>     | Carton box            |
| <b>Packaging quantity</b>        | 10 Pcs                |
| <b>Packaging EAN code</b>        | 8015747021494         |
| <b>Sub-packaging weight</b>      | 1,08 kg               |
| <b>Sub-packaging description</b> | Carton box            |
| <b>Sub-packaging quantity</b>    | 5 Pcs                 |
| <b>Sub-packaging EAN barcode</b> | 8015747021500         |

Part number

# CHP 06 L2



Catalogue drawings

## CHP L CAP L - MHP L MAP L

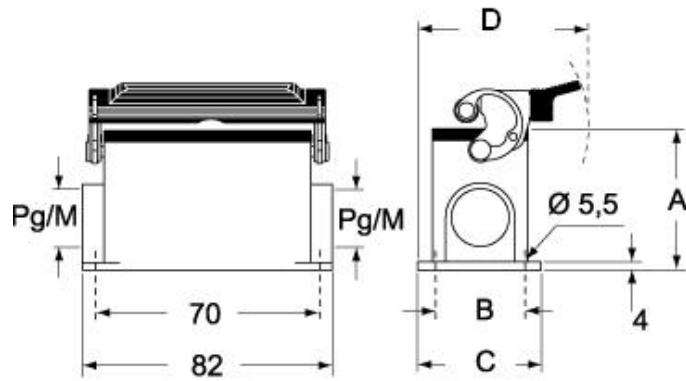

## CHP LS CAP LS - MHP LS MAP LS

