

Part number

CAP 10 CS29



Surface mounting housing, C-TYPE series, with 4 pegs, Pg29 cable entry, size "57.27", high construction, with metal cover

| Product description | |
|---|-------------------------------------|
| Product type | Surface mounting housing |
| Series | C-TYPE |
| Closing type | With 4 pegs |
| Size | Size 57.27 |
| Cable entry | With cable entry Pg29 |
| Specification | High construction, with metal cover |
| Technical data | |
| IP degree of protection | IP65 |
| Further technical details | |
| Weight | 300,00 g |
| Operating temperature range (min, max) | -40°C...+125°C |

| Material properties | |
|----------------------------------|-----------------------|
| Other materials | Gasket: NBR |
| Colour | RAL 7040 grey |
| RoHs conformity | Compliant |
| China RoHs - EFUP | E |
| REACH SVHC substances | No |
| Approvals / Standards | |
| Certifications | DNV, BV |
| UL | ECBT2 |
| cUL | ECBT8 |
| General ordering information | |
| EAN13 code | 8015747007627 |
| Packaging Information | |
| Packaging length | 475,00 mm |
| Packaging height | 200,00 mm |
| Packaging width | 150,00 mm |
| Packaging weight | 3,31 kg |
| Packaging volume | 14,25 dm ³ |
| Packaging description | Carton box |
| Packaging quantity | 10 Pcs |
| Packaging EAN code | 8015747236294 |
| Sub-packaging weight | 1,66 kg |
| Sub-packaging description | Plastic packaging |
| Sub-packaging quantity | 5 Pcs |
| Sub-packaging EAN barcode | 8015747236300 |

Part number

CAP 10 CS29



Catalogue drawings

CHP CAP - MHP MAP

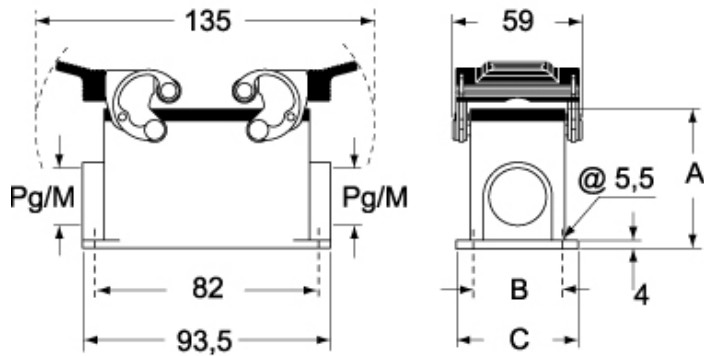

CHP CS/CP CAP CS/CP - MHP CS/CP MAP CS/CP

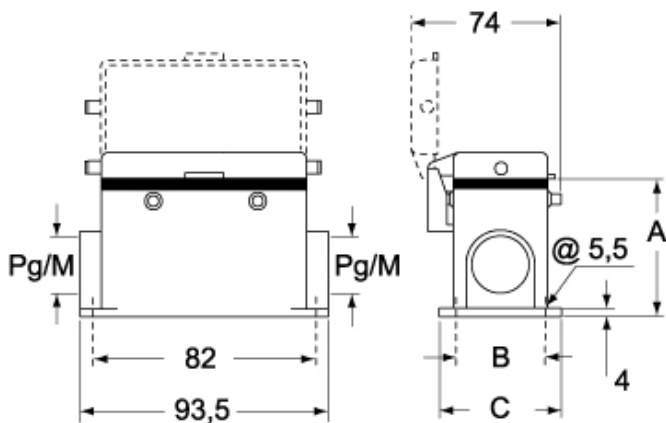

| | A | B | C |
|-----------------|----|----|----|
| CHP L / MHP L | 57 | 40 | 52 |
| CAP L / MAP L | 73 | 45 | 57 |
| CHP CS / MHP CS | 57 | 40 | 52 |
| CAP CS / MAP CS | 73 | 45 | 57 |
| CHP CP / MHP CP | 57 | 40 | 52 |
| CAP CP / MAP CP | 73 | 45 | 57 |