

Part number

# TM 6395 IT



Interlocked switched socket-outlet, TM series, 3 poles + N + PE, 9 h (blue), 63 A, 208 ÷ 250 V, E33 - DIII fuse carrier, with base box

<b>Product description</b>		<b>Material properties</b>	
<b>Product type</b>	Interlocked switched socket-outlet	<b>Colour</b>	RAL 7012 grey, RAL 5015 blue
<b>Series</b>	TM.. IT	<b>RoHs conformity</b>	Compliant with exemption 6(c): copper alloy containing up to 4% lead by weight
<b>N. of poles</b>	3 poles + N + 	<b>China RoHs - EFUP</b>	50
<b>Clock position</b>	9	<b>REACH SVHC substances</b>	Yes Lead
<b>Size</b>	145 x 565 x 18 mm	<b>SCIP number</b>	F6799547-ab84-42f2-938f-233ba663766d
<b>Specification</b>	E33 - DIII fuse carrier With base box	<b>Approvals / Standards</b>	
<b>Technical data</b>		<b>Reference standard</b>	EN 60309-1, -2 e -4
<b>Current</b>	63 A	<b>General ordering information</b>	
<b>Voltage</b>	208 - 250 V	<b>EAN13 code</b>	8015747092869
<b>IP degree of protection</b>	IP66 / IP67	<b>Packaging Information</b>	
<b>Further technical details</b>		<b>Sub-packaging length</b>	150,00 mm
<b>Weight</b>	3.900,00 g	<b>Sub-packaging height</b>	188,00 mm
<b>Operating temperature range (min, max)</b>	-25°C ... +40°C	<b>Sub-packaging width</b>	430,00 mm
<b>UL 94 flammability rating</b>	V-0 (insert), V-2 (enclosure)	<b>Sub-packaging weight</b>	3,90 kg
<b>IK rating (impact degree of protection)</b>	IK10	<b>Sub-packaging volume</b>	12,13 dm <sup>3</sup>
		<b>Sub-packaging description</b>	Carton box
		<b>Sub-packaging quantity</b>	1 Pcs
		<b>Sub-packaging EAN barcode</b>	8015747108997

Part number

# TM 6395 IT



Catalogue drawings

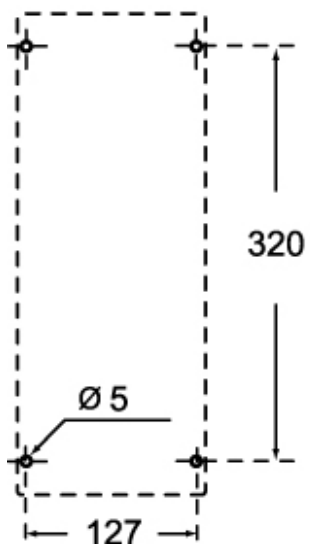

Notes