

Part number

TM 6343 SP



Interlocked switched socket-outlet, TM series, 2 poles + PE, 4 h (yellow), 63 A, 100 ÷ 130 V, without fuse-carrier, with base box

Product description		Material properties	
Product type	Interlocked switched socket-outlet	Colour	RAL 7012 grey, RAL 1021 yellow
Series	TM..SP/KSP	RoHs conformity	Compliant with exemption 6(c): copper alloy containing up to 4% lead by weight
N. of poles	2 poles + 	China RoHs - EFUP	50
Clock position	4	REACH SVHC substances	Yes Lead
Size	145 x 565 x 18 mm	SCIP number	F6799547-ab84-42f2-938f-233ba663766d
Specification	Without fuse-carrier With base box	Approvals / Standards	
Technical data		Reference standard	EN 60309-1, -2 e -4
Current	63 A	General ordering information	
Voltage	100 ÷ 130 V	EAN13 code	8015747100571
IP degree of protection	IP66 / IP67	Packaging Information	
Further technical details		Sub-packaging length	150,00 mm
Weight	3.280,00 g	Sub-packaging height	188,00 mm
Operating temperature range (min, max)	-25°C ... +40°C	Sub-packaging width	430,00 mm
UL 94 flammability rating	V-0 (insert), V-2 (enclosure)	Sub-packaging weight	3,28 kg
IK rating (impact degree of protection)	IK10	Sub-packaging volume	12,13 dm ³
		Sub-packaging description	Carton box
		Sub-packaging quantity	1 Pcs
		Sub-packaging EAN barcode	8015747016728

Part number

TM 6343 SP



Catalogue drawings

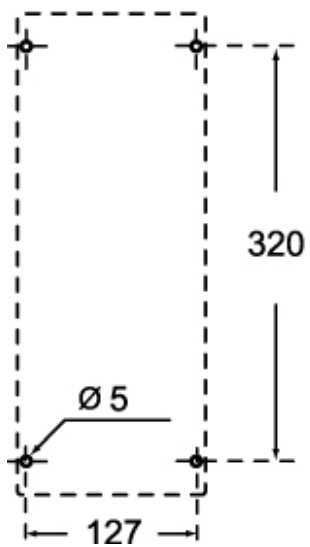

Notes