

Part number

TM 3234 IR



Interlocked switched socket-outlet, TM series, 3 poles + PE, 3 h (red), 32 A, 380 ÷ 380 V, with compartment for modular units, 6 DIN-rail modules EN 60715, with base box

Product description	
Product type	Interlocked switched socket-outlet
Series	TM..IR/KIR
N. of poles	3 poles + 
Clock position	3
Specification	With compartment for modular units, 6 DIN-rail modules EN 60715 With base box

Technical data	
Current	32 A
Voltage	380V (50Hz.) 440V (60Hz.)
IP degree of protection	IP66 / IP67

Further technical details	
Weight	2.720,00 g
Operating temperature range (min, max)	-25°C ... +40°C
UL 94 flammability rating	V-2
IK rating (impact degree of protection)	IK10

Material properties	
Colour	RAL 7012 grey, RAL 3000 red
RoHs conformity	Compliant with exemption 6(c): copper alloy containing up to 4% lead by weight
China RoHs - EFUP	50
REACH SVHC substances	Yes Lead
SCIP number	F6799547-ab84-42f2-938f-233ba663766d

Approvals / Standards	
Reference standard	EN 60309-1, -2 e -4

General ordering information	
EAN13 code	8015747112406

Packaging Information	
Sub-packaging length	150,00 mm
Sub-packaging height	188,00 mm
Sub-packaging width	430,00 mm
Sub-packaging weight	2,72 kg
Sub-packaging volume	12,13 dm ³
Sub-packaging description	Carton box
Sub-packaging quantity	1 Pcs
Sub-packaging EAN barcode	8015747112420

Part number

TM 3234 IR



Catalogue drawings

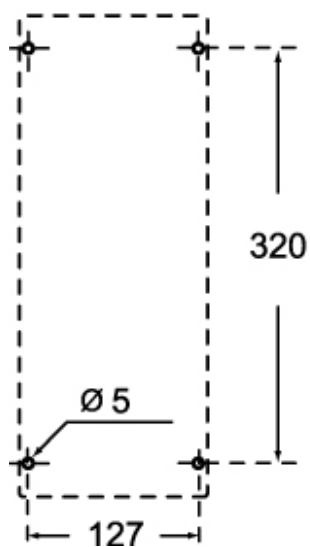

	A
2P+⊕	162
3P+⊕	162
3P+N+⊕	169

Notes