

Part number
SQ 1663



Interlocked switched socket-outlet, SQ series,
 2 poles + PE, 6 h (blue), 16 A, 200 ÷ 250 V,
 without fuse-carrier

Product description

Product type	Interlocked switched socket-outlet
Series	SQ
N. of poles	2 poles + 
Clock position	6
Size	Socket centre distance 115 x 144 mm
Specification	Without fuse-carrier

Technical data

Current	16 A
Voltage	200 ÷ 250 V
IP degree of protection	IP44

Further technical details

Weight	367,00 g
Operating temperature range (min, max)	-25°C ... +40°C
IK rating (impact degree of protection)	IK08

Material properties

Colour	RAL 7035 grey, RAL 5015 blue
RoHs conformity	Compliant with exemption 6(c): copper alloy containing up to 4% lead by weight
China RoHs - EFUP	50
REACH SVHC substances	Yes Lead
SCIP number	Ce861c8d-b979-403b-96d9-80aef6dc281d

Approvals / Standards

Reference standard	EN 60309-1, -2 e -4
---------------------------	---------------------

General ordering information

EAN13 code	8015747084215
-------------------	---------------

Packaging Information

Packaging length	225,00 mm
Packaging height	180,00 mm
Packaging width	435,00 mm
Packaging weight	3,92 kg
Packaging volume	17,62 dm ³
Packaging description	Carton box
Packaging quantity	10 Pcs
Packaging EAN code	8015747084222
Sub-packaging weight	0,39 kg
Sub-packaging description	Plastic packaging
Sub-packaging quantity	1 Pcs
Sub-packaging EAN barcode	8015747084239

Part number

SQ 1663



Catalogue drawings

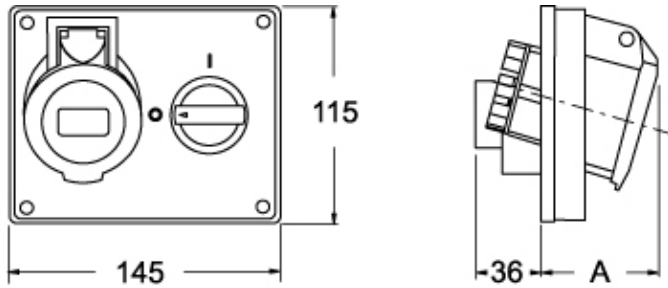

SQ		A
16A	2P+⊕	59
	3P+⊕	63
	3P+N+⊕	63

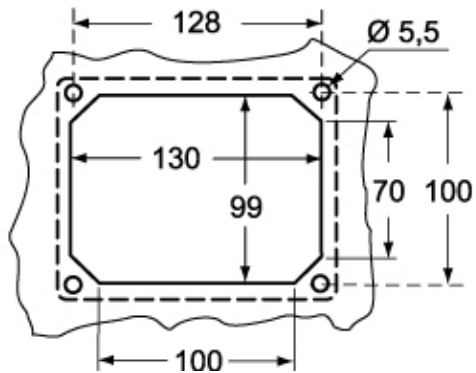

Notes