

Part number

# PK 6363 EB



Interlocked switched socket-outlet, PK series,  
2 poles + PE, 6 h (blue), 63 A, 200 ÷ 250 V,  
without fuse-carrier

Product description		Material properties	
<b>Product type</b>	Interlocked switched socket-outlet	<b>Colour</b>	RAL 7035 grey, RAL 5015 blue
<b>Series</b>	PK..EB		Compliant with exemption 6(c): copper alloy containing up to 4% lead by weight
<b>N. of poles</b>	2 poles + 	<b>RoHs conformity</b>	60
<b>Clock position</b>	6	<b>China RoHs - EFUP</b>	50
<b>Size</b>	114x228 fixing plates FC xx41 TB	<b>REACH SVHC substances</b>	Yes Lead
<b>Cable entry</b>	Pg29	<b>SCIP number</b>	F6799547-ab84-42f2-938f-233ba663766d
<b>Specification</b>	Without fuse-carrier	<b>Approvals / Standards</b>	
<b>Technical data</b>		<b>Reference standard</b>	EN 60309-1, -2 e -4
<b>Current</b>	63 A	<b>General ordering information</b>	
<b>Voltage</b>	200 ÷ 250 V	<b>EAN13 code</b>	8015747082402
<b>IP degree of protection</b>	IP44	<b>Packaging Information</b>	
<b>Further technical details</b>		<b>Packaging length</b>	535,00 mm
<b>Weight</b>	1.704,00 g	<b>Packaging height</b>	320,00 mm
<b>Operating temperature range (min, max)</b>	-25°C ... +40°C	<b>Packaging width</b>	325,00 mm
<b>IK rating (impact degree of protection)</b>	IK10	<b>Packaging weight</b>	15,10 kg
		<b>Packaging volume</b>	55,64 dm <sup>3</sup>
		<b>Packaging description</b>	Carton box
		<b>Packaging quantity</b>	8 Pcs
		<b>Packaging EAN code</b>	8015747082419
		<b>Sub-packaging length</b>	290,00 mm
		<b>Sub-packaging height</b>	125,00 mm
		<b>Sub-packaging width</b>	155,00 mm
		<b>Sub-packaging weight</b>	1,89 kg
		<b>Sub-packaging volume</b>	5,62 dm <sup>3</sup>
		<b>Sub-packaging description</b>	Carton box
		<b>Sub-packaging quantity</b>	1 Pcs
		<b>Sub-packaging EAN barcode</b>	8015747082426

Part number

# PK 6363 EB



## Catalogue drawings

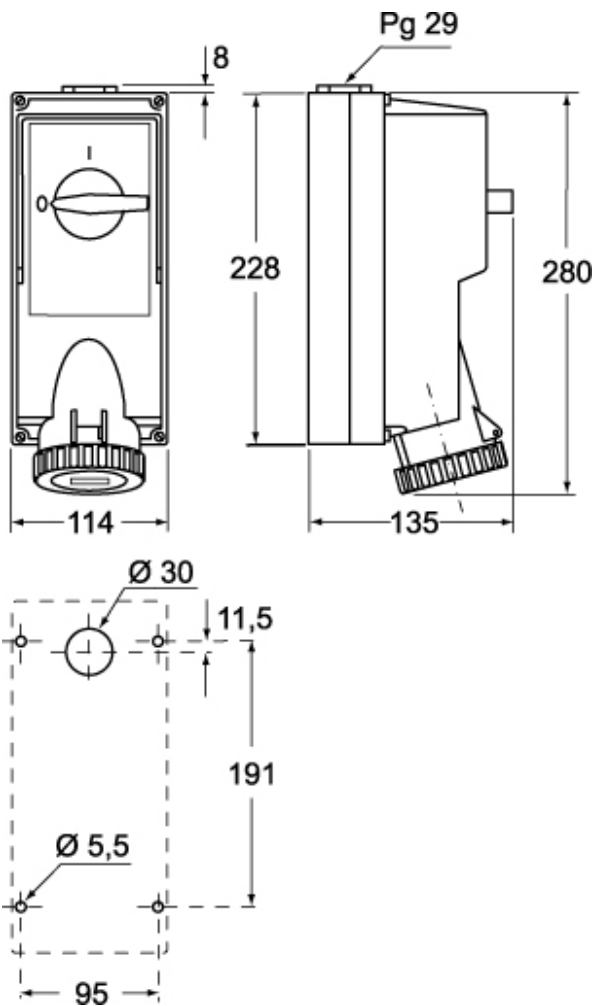

---

Notes