

Part number

PEW 3243 PQ



Flush-mounting socket outlet, PLUSO series, 2 poles + PE, 4 h (yellow), 32 A, 100 ÷ 130 V, straight

Product description

Product type	Socket Flush-mounting
Series	PEW...PQ, PLUSO
N. of poles	2 poles + 
Clock position	4
Size	Socket fixing centre distance 60 x 60 mm
Specification	Straight

Technical data

Current	32 A
Voltage	100 ÷ 130 V
IP degree of protection	IP67
Further technical details	
Weight	235,00 g
Operating temperature range (min, max)	-25°C ... +40°C

Material properties

Colour	RAL 7035 grey, RAL 1021 yellow
RoHs conformity	Compliant with exemption 6(c): copper alloy containing up to 4% lead by weight
China RoHs - EFUP	50
REACH SVHC substances	Yes Lead
SCIP number	Ca7de37f-add8-4b77-9861-279c94903ade

Approvals / Standards

Reference standard	EN 60309-1 and -2
---------------------------	-------------------

General ordering information

EAN13 code	8015747074681
-------------------	---------------

Packaging Information

Packaging length	255,00 mm
Packaging height	195,00 mm
Packaging width	245,00 mm
Packaging weight	2,57 kg
Packaging volume	12,18 dm ³
Packaging description	Carton box
Packaging quantity	10 Pcs
Packaging EAN code	8015747074698

Part number

PEW 3243 PQ



Catalogue drawings

(16 / 32A) PEW ... PQ

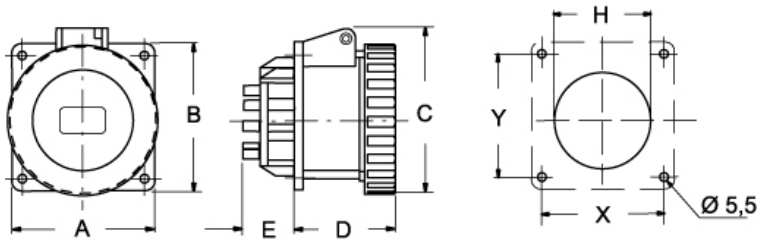

PEW ... PQ	A	B	C	D	E	H	X	Y
16A 2P+⊕	65	65	77	52	27	60	52	52
	65	65	85	52	27	61,5	52	52
	80	80	93	52	27	70	60	60
32A 2P+⊕	80	80	98	62	28	68	60	60
	80	80	98	62	28	68	60	60
	80	80	105	62	28	73	60	60

Notes