

Part number

PEW 1674 PQF



Flush-mounting socket outlet, PLUSO series, 3 poles + PE, 7 h (black), 16 A, 480 ÷ 500 V, straight, with bigger flange

Product description		Material properties	
Product type	Socket Flush-mounting	Colour	RAL 7035 grey, RAL 9005 black
Series	PEW...PQF, PLUSO	RoHs conformity	Compliant with exemption 6(c): copper alloy containing up to 4% lead by weight
N. of poles	3 poles + 	China RoHs - EFUP	50
Clock position	7	REACH SVHC substances	Yes Lead
Specification	Straight, bigger flange	SCIP number	Ca7de37f-add8-4b77-9861-279c94903ade
Technical data		Approvals / Standards	
Current	16 A	Reference standard	EN 60309-1 and -2
Voltage	480 ÷ 500 V	General ordering information	
IP degree of protection	IP67	EAN13 code	8015747073264
Further technical details		Packaging Information	
Weight	174,00 g	Packaging length	285,00 mm
Operating temperature range (min, max)	-25°C ... +40°C	Packaging height	170,00 mm
		Packaging width	190,00 mm
		Packaging weight	1,95 kg
		Packaging volume	9,21 dm ³
		Packaging description	Carton box
		Packaging quantity	10 Pcs
		Packaging EAN code	8015747073271

Part number

PEW 1674 PQF



Catalogue drawings

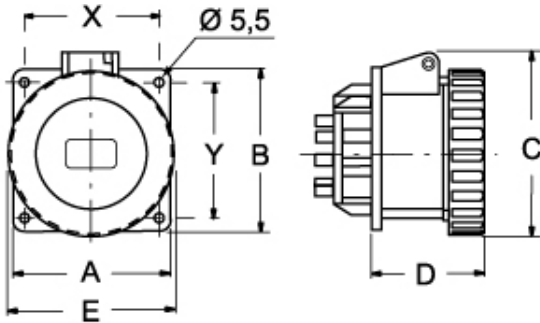

		A	B	C	D	E	X	Y
PQF 16 A	2P+⊖	80	80	--	52	70	60	60
	3P+⊖	80	80	--	52	78	60	60
PQ 16 A	2P+⊖	65	65	77	52	70	52	52
	3P+⊖	65	65	85	52	78	52	52
	3P+N+⊖	80	80	93	52	86	60	60
PQ 32 A	2P+⊖	80	80	98	62	92	60	60
	3P+⊖	80	80	98	62	92	60	60
	3P+N+⊖	80	80	105	62	100	60	60

Notes