

Part number

PEW 12564 PQ



Flush-mounting socket outlet, PLUSO series, 3 poles + PE, 6 h (red), 125 A, 380 ÷ 415 V, straight

Product description

Product type	Socket Flush-mounting
Series	PEW...PQ, PLUSO
N. of poles	3 poles + 
Clock position	6
Specification	Straight

Technical data

Current	125 A
Voltage	380 ÷ 415 V
IP degree of protection	IP67

Further technical details

Weight	1.495,00 g
Operating temperature range (min, max)	-25°C ... +40°C

Material properties

Colour	RAL 7035 grey, RAL 3000 red
RoHs conformity	Compliant with exemption 6(c): copper alloy containing up to 4% lead by weight
China RoHs - EFUP	50
REACH SVHC substances	Yes Lead
SCIP number	Ca7de37f-add8-4b77-9861-279c94903ade

Approvals / Standards

Reference standard	EN 60309-1 and -2
---------------------------	-------------------

General ordering information

EAN13 code	8015747070393
-------------------	---------------

Packaging Information

Packaging length	335,00 mm
Packaging height	320,00 mm
Packaging width	400,00 mm
Packaging weight	13,20 kg
Packaging volume	42,88 dm ³
Packaging description	Carton box
Packaging quantity	8 Pcs
Packaging EAN code	8015747070409
Sub-packaging weight	1,65 kg
Sub-packaging description	Carton box
Sub-packaging quantity	1 Pcs
Sub-packaging EAN barcode	8015747070416

Part number

PEW 12564 PQ



Catalogue drawings

(63 / 125A) PEW ... PQ

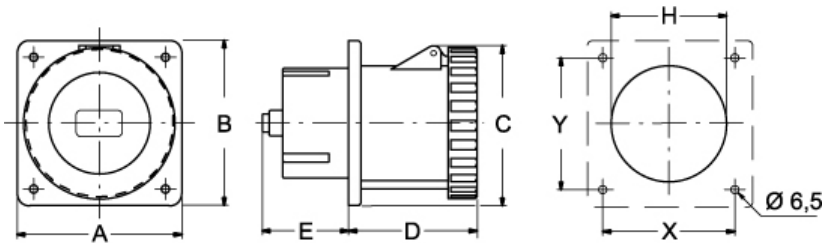

PEW ... PQ	A	B	C	D	E	H	X	Y
63A 2P+⊕	100	107	109	92	30	73	77	85
3P+⊕	100	107	109	92	30	73	77	85
3P+N+⊕	100	107	109	92	30	73	77	85
125A 2P+⊕	130	130	130	101	68	91	104	104
3P+⊕	130	130	130	101	68	91	104	104
3P+N+⊕	130	130	130	101	68	91	104	104

Notes