

Part number

PE 1675 SM



Wall-mounting plug, PLUSO series, 3 poles + N + PE, 7 h (black), 16 A, 277/480 ÷ 288/500 V

Product description		Material properties	
Product type	Plug Wall-mounting	Colour	RAL 7035 grey, RAL 9005 black
Series	PE...SM, PLUSO	RoHs conformity	Compliant with exemption 6(c): copper alloy containing up to 4% lead by weight
N. of poles	3 poles + N + 	China RoHs - EFUP	50
Clock position	7	REACH SVHC substances	Yes Lead
Technical data		SCIP number	Ca7de37f-add8-4b77-9861-279c94903ade
Current	16 A	Approvals / Standards	
Voltage	277/480 ÷ 288/500 V	Reference standard	EN 60309-1 and -2
IP degree of protection	IP44	General ordering information	
Further technical details		EAN13 code	8015747065214
Weight	183,00 g	Packaging Information	
Operating temperature range (min, max)	-25°C ... +40°C	Packaging length	340,00 mm
		Packaging height	135,00 mm
		Packaging width	200,00 mm
		Packaging weight	1,95 kg
		Packaging volume	9,18 dm ³
		Packaging description	Carton box
		Packaging quantity	10 Pcs
		Packaging EAN code	8015747065221

Part number

PE 1675 SM



Catalogue drawings

(16 / 32A) PE ... SM

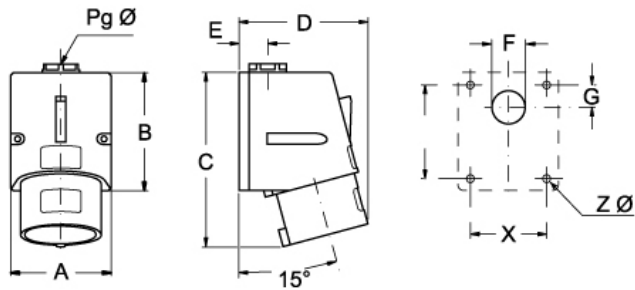

PE ... SM	A	B	C	D	E	F	G	X	Y	Z Ø	Pg Ø
16A 2P+⊕	70	82	115	75	20	23	16	53	65	4,5	16
3P+⊕	70	82	117	75	20	23	16	53	65	4,5	16
3P+N+⊕	70	82	121	90	20	23	16	53	65	4,5	16
32A 2P+⊕	86	104	145	95	24	29	17	61	79	6,5	21
3P+⊕	86	104	145	95	24	29	17	61	79	6,5	21
3P+N+⊕	86	104	147	95	24	29	17	61	79	6,5	21

Notes