

Part number

PE 1643 SA



Mobile plug, PLUSO series, 2 poles + PE, 4 h (yellow), 16 A, 100 ÷ 130 V, angled

| Product description | | Material properties | |
|---|---|----------------------------------|---|
| Product type | Plug Mobile | Colour | RAL 7035 grey, RAL 1021 yellow |
| Series | PE...SA, PLUSO | RoHs conformity | Compliant with exemption 6(c): copper alloy containing up to 4% lead by weight |
| N. of poles | 2 poles +  | China RoHs - EFUP | 50 |
| Clock position | 4 | REACH SVHC substances | Yes Lead |
| Specification | Angled | SCIP number | Ca7de37f-add8-4b77-9861-279c94903ade |
| Technical data | | Approvals / Standards | |
| Current | 16 A | Reference standard | EN 60309-1 and -2 |
| Voltage | 100 ÷ 130 V | General ordering information | |
| IP degree of protection | IP44 | EAN13 code | 8015747063838 |
| Further technical details | | Packaging Information | |
| Weight | 99,00 g | Sub-packaging length | 140,00 mm |
| Operating temperature range (min, max) | -25°C ... +40°C | Sub-packaging height | 135,00 mm |
| | | Sub-packaging width | 235,00 mm |
| | | Sub-packaging weight | 0,99 kg |
| | | Sub-packaging volume | 4,44 dm ³ |
| | | Sub-packaging description | Carton box |
| | | Sub-packaging quantity | 10 Pcs |
| | | Sub-packaging EAN barcode | 8015747063845 |

Part number

PE 1643 SA



Catalogue drawings

(16 / 32A) PE ... SA

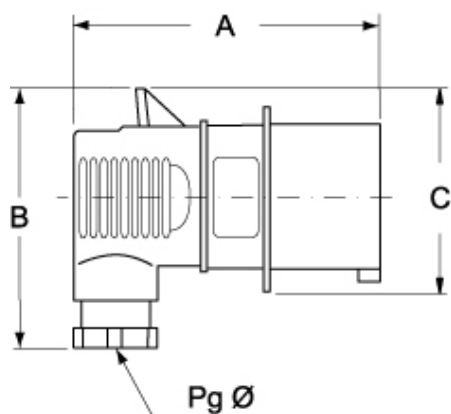

| PE...SA | A | B | C | Pg Ø |
|-----------------|-----|-----|----|------|
| 16A 2P+⊕ | 100 | 77 | 59 | 13,5 |
| 3P+⊕ | 100 | 84 | 68 | 16 |
| 3P+N+⊕ | 106 | 91 | 77 | 16 |
| 32A 2P+⊕ | 131 | 100 | 82 | 21 |
| 3P+⊕ | 131 | 100 | 82 | 21 |
| 3P+N+⊕ | 131 | 107 | 93 | 21 |

Notes