

Part number

MKX IAP25



Angled Bulkhead mounting housing, CK series, with 1 lever, M25 cable entry, size "21.21", fixing by 4 screws

Product description

| | |
|----------------------|----------------------------------|
| Product type | Angled bulkhead mounting housing |
| Series | CK |
| Closing type | With 1 lever |
| Size | Size "21.21" |
| Cable entry | With cable entry M25 |
| Specification | Fixing by 4 screws |

Technical data

IP degree of protection IP44 - IP66 / IP67 / IP69 with CKR 65 (D)

Further technical details

| | |
|---|----------------|
| Weight | 25,50 g |
| Operating temperature range (min, max) | -40°C...+125°C |

Material properties

| | |
|------------------------------|---------------------------------------|
| Other materials | Lever: Stainless steel Gasket: TPE |
| Colour | RAL 7035 grey |
| RoHs conformity | Compliant |
| China RoHs - EFUP | E |
| REACH SVHC substances | No |

General ordering information

| | |
|-------------------|---------------|
| EAN13 code | 8015747224758 |
| eCl@ss 8.1 | 27440202 |
| ETIM 7.0 | EC000437 |

Packaging Information

| | |
|----------------------------------|-----------------------|
| Packaging length | 375,00 mm |
| Packaging height | 230,00 mm |
| Packaging width | 205,00 mm |
| Packaging weight | 2,86 kg |
| Packaging volume | 17,68 dm ³ |
| Packaging description | Carton box |
| Packaging quantity | 100 Pcs |
| Packaging EAN code | 8015747303477 |
| Sub-packaging weight | 0,29 kg |
| Sub-packaging description | Carton box |
| Sub-packaging quantity | 10 Pcs |
| Sub-packaging EAN barcode | 8015747303484 |

Part number

MKX IAP25



Catalogue drawings

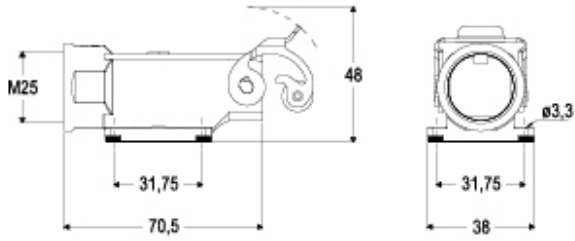

Notes