

Part number

MHV 16 LG32



Hood, C-TYPE series, with 1 lever, M32 top cable entry, size "77.27"

Product description

| | |
|---------------------|------------------------|
| Product type | Hood |
| Series | C-TYPE |
| Closing type | With 1 lever |
| Size | Size 77.27 |
| Cable entry | Top cable entry M32 |

Technical data

IP degree of protection IP65 / IP66 / IP69

Further technical details

| | |
|-----------------------------------------------|----------------|
| Weight | 2,20 g |
| Operating temperature range (min, max) | -40°C...+125°C |

Material properties

| | |
|------------------------------|-------------------------------------------------------|
| Other materials | Lever: Stainless steel, polyamide (PA) Gasket: NBR |
| Colour | RAL 7040 grey |
| RoHs conformity | Compliant |
| China RoHs - EFUP | E |
| REACH SVHC substances | No |

Approvals / Standards

| | |
|-----------------------|---------|
| Certifications | DNV, BV |
| UL | ECBT2 |
| cUL | ECBT8 |

General ordering information

| | |
|-------------------|---------------|
| EAN13 code | 8015747055819 |
| eCl@ss 8.1 | 27440202 |
| ETIM 7.0 | EC000437 |

Packaging Information

| | |
|----------------------------------|----------------------|
| Packaging length | 255,00 mm |
| Packaging height | 150,00 mm |
| Packaging width | 180,00 mm |
| Packaging weight | 2,25 kg |
| Packaging volume | 6,89 dm ³ |
| Packaging description | Carton box |
| Packaging quantity | 10 Pcs |
| Packaging EAN code | 8015747055826 |
| Sub-packaging weight | 1,13 kg |
| Sub-packaging description | Plastic packaging |
| Sub-packaging quantity | 5 Pcs |
| Sub-packaging EAN barcode | 8015747055833 |

Part number

MHV 16 LG32



Catalogue drawings

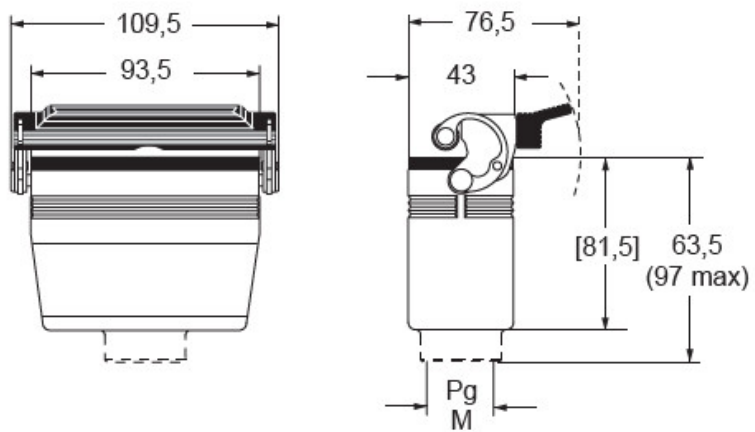

Notes