

Part number

# MHPW 48 LS40



Surface mounting housing, W-TYPE series, with 1 lever, M40 cable entry, size "104.62", with metal cover

## Product description

|                      |                          |
|----------------------|--------------------------|
| <b>Product type</b>  | Surface mounting housing |
| <b>Series</b>        | W-TYPE                   |
| <b>Closing type</b>  | With 1 lever             |
| <b>Size</b>          | Size 104.62              |
| <b>Cable entry</b>   | With cable entry<br>M40  |
| <b>Specification</b> | With metal cover         |

## Technical data

|                                |      |
|--------------------------------|------|
| <b>IP degree of protection</b> | IP65 |
|--------------------------------|------|

## Further technical details

|   |                |
|---|----------------|
| <b>Weight</b>                                 | 2,50 g         |
| <b>Operating temperature range (min, max)</b> | -40°C...+125°C |

## Material properties

|                              |  |
|------------------------------|--|
| <b>Other materials</b>       | Lever: Stainless steel, polyamide (PA) |
| <b>Colour</b>                | RAL 9005 black                         |
| <b>RoHs conformity</b>       | Compliant                              |
| <b>China RoHs - EFUP</b>     | E                                      |
| <b>REACH SVHC substances</b> | No                                     |

## Approvals / Standards

|                       |         |
|-----------------------|---------|
| <b>Certifications</b> | DNV, BV |
| <b>UL</b>             | ECBT2   |
| <b>cUL</b>            | ECBT8   |

## General ordering information

|                   |               |
|-------------------|---------------|
| <b>EAN13 code</b> | 8015747152716 |
| <b>eCl@ss 8.1</b> | 27440202      |
| <b>ETIM 7.0</b>   | EC000437      |

## Packaging Information

|                                  |                       |
|----------------------------------|-----------------------|
| <b>Packaging length</b>          | 305,00 mm             |
| <b>Packaging height</b>          | 180,00 mm             |
| <b>Packaging width</b>           | 275,00 mm             |
| <b>Packaging volume</b>          | 15,10 dm <sup>3</sup> |
| <b>Packaging description</b>     | Carton box            |
| <b>Packaging quantity</b>        | 4 Pcs                 |
| <b>Packaging EAN code</b>        | 8015747208758         |
| <b>Sub-packaging description</b> | Plastic packaging     |
| <b>Sub-packaging quantity</b>    | 1 Pcs                 |
| <b>Sub-packaging EAN barcode</b> | 8015747208765         |

Part number

# MHPW 48 LS40



## Catalogue drawings

CHIW LS

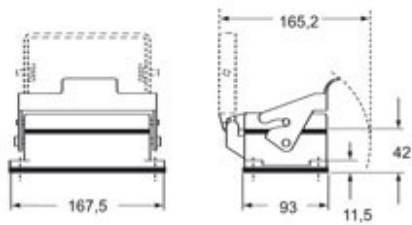

CHPW LS MHPW LS

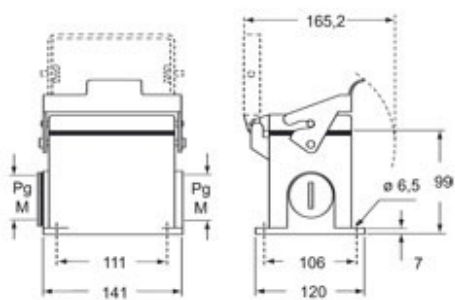

Notes