

Part number

M7PE 16.25



Surface mounting housing, E-Xtreme® V-TYPE series, with 2 levers, M25 cable entry, size "77.27"

Product description

Product type	Surface mounting housing
Series	E-Xtreme® V-TYPE
Closing type	With 2 levers
Size	Size 77.27
Cable entry	With cable entry M25

Technical data

IP degree of protection IP66 / IP67 / IP69

Further technical details

Operating temperature range (min, max) -40°C...+125°C

Material properties

Other materials	Lever: Stainless steel Gasket: FKM
Colour	RAL 7016 grey
RoHs conformity	Compliant
China RoHs - EFUP	E
REACH SVHC substances	No

Approvals / Standards

Certifications	DNV, BV
UL	ECBT2
cUL	ECBT8

General ordering information

EAN13 code	8015747254236
eCl@ss 8.1	27440202
ETIM 7.0	EC000437

Part number

M7PE 16.25



Catalogue drawings

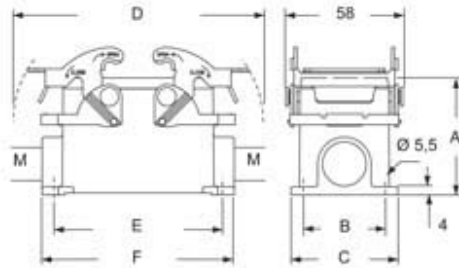

type	A	B	C	D	E	F
M7PE 16	63	45	57	142,5	105	117
M7APE 16	77	45	57	142,5	105	117

Notes