

Part number

M7APE 24.40



Surface mounting housing, E-Xtreme® V-TYPE series, with 2 levers, M40 cable entry, size "104.27", high construction

Product description		Material properties	
Product type	Surface mounting housing	Other materials	Lever: Stainless steel Gasket: FKM
Series	E-Xtreme® V-TYPE	Colour	RAL 7016 grey
Closing type	With 2 levers	RoHs conformity	Compliant
Size	Size 104.27	China RoHs - EFUP	E
Cable entry	With cable entry M40	REACH SVHC substances	No
Specification	High construction	Approvals / Standards	
Technical data		Certifications	DNV, BV
IP degree of protection	IP66 / IP67 / IP69	UL	ECBT2
Further technical details		cUL	ECBT8
Operating temperature range (min, max)	-40°C...+125°C	General ordering information	
		EAN13 code	8015747254199
		eCl@ss 8.1	27440202
		ETIM 7.0	EC000437

Part number

M7APE 24.40



Catalogue drawings

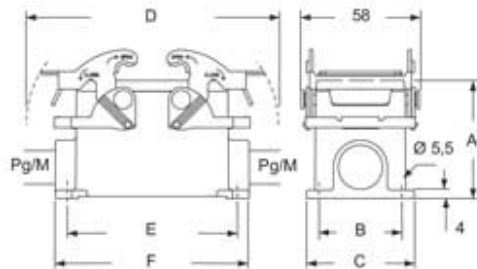

type	A	B	C	D	E	F
M7P 24	63	45	57	169	132	144
M7AP 24	80	45	57	169	132	144

Notes