

Part number

JMPP 16 L25



Surface mounting housing, JEI®-P series, with 1 lever, M25 cable entry, size 77.27

Product description		Material properties	
Product type	Surface mounting housing	Other materials	Lever: Polyamide (PA) Gasket: NBR
Series	JEI®-P	Colour	RAL 7040 grey
Closing type	With 1 lever	Approvals / Standards	
Size	Size 77.27	Certifications	DNV, BV
Cable entry	With cable entry M25	General ordering information	
Technical data		EAN13 code	8015747303682
IP degree of protection	IP65	Packaging Information	
Further technical details		Packaging length	475,00 mm
Weight	1,00 g	Packaging height	180,00 mm
Operating temperature range (min, max)	-40°C...+125°C	Packaging width	175,00 mm
		Packaging volume	14,96 dm ³
		Packaging description	Carton box
		Packaging quantity	10 Pcs
		Packaging EAN code	8015747027632
		Sub-packaging description	Plastic packaging
		Sub-packaging quantity	5 Pcs
		Sub-packaging EAN barcode	8015747027649

Part number

JMPP 16 L25



Catalogue drawings

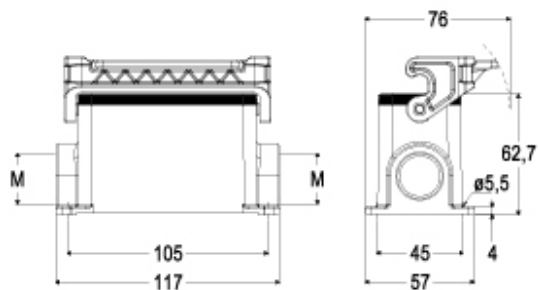

Notes