

Part number

JMPAP 16.32



Surface mounting housing, JEl®-P series, with 2 levers, M32 cable entry, size 77.27, high construction

Product description		Material properties	
Product type	Surface mounting housing	Other materials	Lever: Polyamide (PA) Gasket: NBR
Series	JEl®-P	Colour	RAL 7040 grey
Closing type	With 2 levers	Approvals / Standards	
Size	Size 77.27	Certifications	DNV, BV
Cable entry	With cable entry M32	General ordering information	
Specification	High construction	EAN13 code	8015747091619
Technical data		Packaging Information	
IP degree of protection	IP65	Packaging length	250,00 mm
Further technical details		Packaging height	145,00 mm
Weight	380,00 g	Packaging width	300,00 mm
Operating temperature range (min, max)	-40°C...+125°C	Packaging weight	4,07 kg
		Packaging volume	10,88 dm ³
		Packaging description	Carton box
		Packaging quantity	10 Pcs
		Packaging EAN code	8015747248259
		Sub-packaging weight	2,04 kg
		Sub-packaging description	Plastic packaging
		Sub-packaging quantity	5 Pcs
		Sub-packaging EAN barcode	8015747091626

Part number

JMPAP 16.32



Catalogue drawings

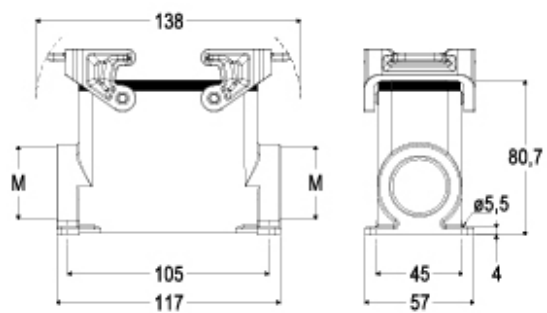

Notes