

Part number

# JMPAP 10.232



Surface mounting housing, JEI®-P series, with 2 levers, M32 x 2 cable entry, size 57.27, high construction

#### Product description

<b>Product type</b>	Surface mounting housing
<b>Series</b>	JEI®-P
<b>Closing type</b>	With 2 levers
<b>Size</b>	Size 57.27
<b>Cable entry</b>	With cable entry M32 x 2
<b>Specification</b>	High construction

#### Technical data

**IP degree of protection** IP65

#### Further technical details

<b>Weight</b>	296,00 g
<b>Operating temperature range (min, max)</b>	-40°C...+125°C

#### Material properties

<b>Other materials</b>	Lever: Polyamide (PA) Gasket: NBR
<b>Colour</b>	RAL 7040 grey

#### Approvals / Standards

**Certifications** DNV, BV

#### General ordering information

**EAN13 code** 8015747219068

#### Packaging Information

<b>Packaging weight</b>	3,25 kg
<b>Packaging volume</b>	12,11 dm <sup>3</sup>
<b>Packaging description</b>	Carton box
<b>Packaging quantity</b>	10 Pcs
<b>Packaging EAN code</b>	8015747268462
<b>Sub-packaging weight</b>	1,63 kg
<b>Sub-packaging description</b>	Plastic packaging
<b>Sub-packaging quantity</b>	5 Pcs
<b>Sub-packaging EAN barcode</b>	8015747268479

Part number

# JMPAP 10.232



## Catalogue drawings

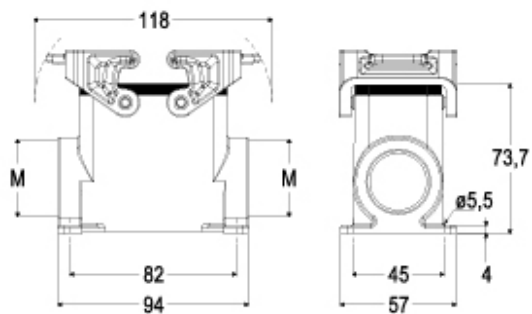

---

Notes