

Part number

# JMPAP 06L232



Surface mounting housing, JEI®-P series, with 1 lever, M32 x 2 cable entry, size "44.27", high construction

Product description		Material properties	
<b>Product type</b>	Surface mounting housing	<b>Colour</b>	RAL 7040 grey
<b>Series</b>	JEI®-P	<b>Approvals / Standards</b>	
<b>Closing type</b>	With 1 lever	<b>Certifications</b>	DNV, BV
<b>Size</b>	Size 44.27	<b>General ordering information</b>	
<b>Cable entry</b>	With cable entry M32 x 2	<b>EAN13 code</b>	8015747219051
<b>Specification</b>	High construction	<b>Packaging Information</b>	
<b>Technical data</b>		<b>Packaging length</b>	475,00 mm
<b>IP degree of protection</b>	IP65	<b>Packaging height</b>	200,00 mm
<b>Further technical details</b>		<b>Packaging width</b>	150,00 mm
<b>Weight</b>	255,00 g	<b>Packaging weight</b>	2,55 kg
<b>Operating temperature range (min, max)</b>	-40°C...+125°C	<b>Packaging volume</b>	14,25 dm <sup>3</sup>
		<b>Packaging description</b>	Carton box
		<b>Packaging quantity</b>	10 Pcs
		<b>Packaging EAN code</b>	8015747248662
		<b>Sub-packaging weight</b>	1,28 kg
		<b>Sub-packaging description</b>	Plastic packaging
		<b>Sub-packaging quantity</b>	5 Pcs
		<b>Sub-packaging EAN barcode</b>	8015747239929

Part number

# JMPAP 06L232



## Catalogue drawings

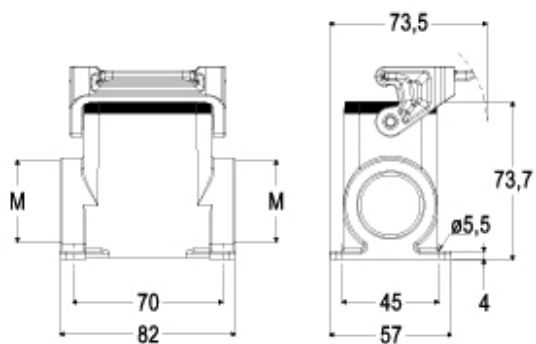

---

Notes