

Part number

JMPAP 06 L32



Surface mounting housing, JEl®-P series, with 1 lever, M32 cable entry, size 44.27, high construction

Product description

Product type	Surface mounting housing
Series	JEl®-P
Closing type	With 1 lever
Size	Size 44.27
Cable entry	With cable entry M32
Specification	High construction

Technical data

IP degree of protection IP65

Further technical details

Weight	250,00 g
Operating temperature range (min, max)	-40°C...+125°C

Material properties

Other materials	Lever: Polyamide (PA) Gasket: NBR
Colour	RAL 7040 grey

Approvals / Standards

Certifications	DNV, BV
-----------------------	---------

General ordering information

EAN13 code	8015747091565
-------------------	---------------

Packaging Information

Packaging length	475,00 mm
Packaging height	200,00 mm
Packaging width	150,00 mm
Packaging weight	2,83 kg
Packaging volume	14,25 dm ³
Packaging description	Carton box
Packaging quantity	10 Pcs
Packaging EAN code	8015747248648
Sub-packaging weight	1,42 kg
Sub-packaging description	Plastic packaging
Sub-packaging quantity	5 Pcs
Sub-packaging EAN barcode	8015747091572

Part number

JMPAP 06 L32



Catalogue drawings

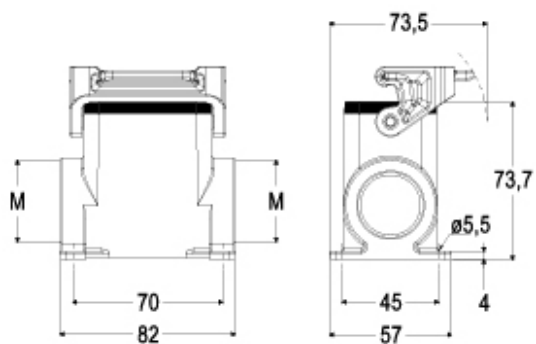

Notes